

# PRODUCT GUIDE



# PRODUCT GUIDE

A division of the well-respected BCI Acrylic Baths brand line, Prime Baths is swiftly establishing itself in the North American bath remodeling industry. Prime Baths represents top quality products and services. As THE bathroom specialists, we offer custom-fitted acrylic tubs and showers in a wide variety of selections. Because everyone wants their remodeling done yesterday, our certified installation teams can complete the job in as little as one day. Our mold resistant acrylic is easy to clean and inhibits mildew growth. We're revolutionizing the bath industry with beautiful, yet affordable products.

Take a moment to review the catalog selections and see for yourself why our clients love us.

— *Scott Rosenbach, President & Owner*



# TABLE OF CONTENTS

## BATHTUBS

STANDARD SIZE REPLACEMENT BATHTUBS .....	2
CUSTOM ACRYLIC SPRAY FOAM BATHTUBS .....	4
ACRYLIC BATHTUB LINERS .....	8
WALK-IN & WALK-THRU .....	12
BATHTUB DRAINS.....	24

## SHOWERS

STANDARD SIZE REPLACEMENT SHOWER BASES.....	28
CUSTOM ACRYLIC SHOWER BASES .....	32
ACRYLIC SHOWER LINERS.....	38
SHOWER DRAINS.....	40

ACRYLIC WALL SURROUNDS .....	42
------------------------------	----

## ACCESSORIES

ACRYLIC WALL ACCESSORIES & TRIM.....	52
METAL ACCESSORIES AND FIXTURES .....	68

BATHTUB AND SHOWER SEATING .....	86
----------------------------------	----

SHOWER AND BATHTUB DOORS .....	92
--------------------------------	----

INSTALLATION PRODUCTS .....	106
-----------------------------	-----

SALES TOOLS .....	116
-------------------	-----

CARE AND WARRANTY .....	120
-------------------------	-----

# ***STANDARD SIZE ACRYLIC REPLACEMENT BATHTUBS***





## STANDARD SIZE ACRYLIC REPLACEMENT BATHTUB MATRIX

PRODUCT STYLES		DIMENSIONS	COLORS				
			White	Almond	Biscuit	Gray	Sandbar
REPLACEMENT TUBS WITH SKIRT	Classic	60" x 30" x 15" L/R	X	X	X	X	X
	Straight	60" x 30" x 15" L/R	X	X	X	X	X
	Straight (AFR)	60" x 30" x 18" L/R	X				
	Classic	60" x 32" x 15" L/R	X	X	X	X	X
	Straight	60" x 32" x 15" L/R	X	X	X	X	X
SOAKER TUB	Straight	60" x 32" x 19" L/R	X	X	X	X	X
	Contour	60" x 32" x 19" L/R	X	X	X	X	X
	Linear	60" x 32" x 19" L/R	X	X	X	X	X
	Linear	60" x 36" x 19" L/R	X	X	X	X	X

Our distinctive line of replacement bathtubs and a variety of stylish skirts make these the ideal solution for outdated bathroom remodeling projects.

- Available in: White, Almond, Biscuit, Gray and Sandbar
- Constructed from DR-ABS acrylic
- Reinforced with high density structural fiberglass
- Built-in nail flange
- One-piece acrylic construction with integrated skirt



Classic



Linear



Straight

# ***CUSTOM ACRYLIC REPLACEMENT BATHTUBS***





## CUSTOM ACRYLIC REPLACEMENT BATHTUB MATRIX

PRODUCT STYLES		DIMENSIONS	COLORS				
			White	Almond	Biscuit	Gray	Sandbar
SPRAY FOAM TUBS	Straight	4' x Custom Width/Depth	X	X	X	X	X
	Straight	4.5' x Custom Width/Depth	X	X	X	X	X
	Curved	4.5' x Custom Width/Depth	X	X	X	X	X
	Surf	4.5' x Custom Width/Depth	X	X	X	X	X
	Wave	4.5' x Custom Width/Depth	X	X	X	X	X
	Winged	4.5' x Custom Width/Depth	X	X	X	X	X
	Straight	5' x Custom Width/Depth	X	X	X	X	X
	Classic	5' x Custom Width/Depth	X	X	X	X	X
	Curved	5' x Custom Width/Depth	X	X	X	X	X
	Surf	5' x Custom Width/Depth	X	X	X	X	X
	Wave	5' x Custom Width/Depth	X	X	X	X	X
	Winged	5' x Custom Width/Depth	X	X	X	X	X
	Straight	5.5' x Custom Width/Depth	X	X	X	X	X
	Winged	5.5' x Custom Width/Depth	X	X	X		

5.5 FT	Depth (inches)	Width (inches)	Skirt
	15"	30, 31, 32, 33, 34	Straight, Classic, Winged
	17"	30, 31, 32, 33, 34	Straight, Classic, Winged
5 FT	Depth	Width	Skirt
	13"	30, 31, 32	Straight, Classic, Curved, Surf, Wave, Winged
	13"	28, 29, 33, 34	Straight
	15"	31, 32	Straight, Classic, Curved, Surf, Wave, Winged
	15"	30	Straight, Classic, Wave, Winged
	15"	33, 34	Straight
	17"	30, 31, 32, 33, 34	Straight
	19"	32	Straight - (New deep soaker with stylish armrests - in white only)
4.5 FT	Depth	Width	Skirt
	13"	30, 31, 32	Straight, Wave, Winged
	13"	28, 29	Straight
	15"	30, 31, 32	Straight, Surf, Wave, Winged
	17"	30, 31, 32	Straight
4 FT	Depth	Width	Skirt
	12"	28, 29, 30	Straight
	15"	28, 29, 30	Straight

\*All lengths available from 4' to 5.5' and every length in between in .5" increments.

Custom widths increase by the half inch

# CUSTOM ACRYLIC SPRAY FOAM TUBS

Our distinctive line of replacement bathtubs and a variety of stylish skirts make these the ideal solution for outdated bathroom remodeling projects.

- Available in: White, Almond, Biscuit, Gray and Sandbar
- Constructed from DR-ABS acrylic
- Reinforced with high density structural foam
- Available in 4.5', 5' and 5.5' Tubs



Classic = SFCL  
(Offset: 1.5")



Surf = SFSU  
(No offset)

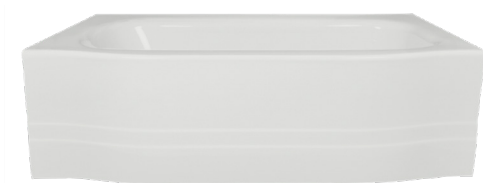

Curved Skirt = SFCU  
(No offset)



Wave = SFWA  
(No offset)



Straight Skirt = SFST  
(No offset)



Winged = SFWG  
(Offset: 1.5")



## SOAKER TUBS

Soaker tubs are deeper than a standard tub and include built-in armrests for added comfort.

- Available in: White, Biscuit, Almond, Gray and Sandbar.
- Contour, Linear and Straight skirt options
- Constructed from DR-ABS acrylic
- Requires Drain, Overflow and Solvent Weld Assembly
- Dimensions:  
60"L x 32"W x 19"D  
60"L x 36"W x 19"D



An optional neck rest adds comfort to your soaker tub experience.

- Available in: Gray



OPTIONAL NECK REST



# ***ACRYLIC BATHTUB LINERS***





## ACRYLIC BATHTUB LINER MATRIX

PRODUCT STYLES		DIMENSIONS	COLORS				
			White	Almond	Biscuit	Gray	Sandbar
BATHTUB LINERS	Curved	4.5' x Custom Width/Depth	X	X	X	X	X
	Straight	4.5' x Custom Width/Depth	X	X	X	X	X
	Surf	4.5' x Custom Width/Depth	X	X	X	X	X
	Winged	4.5' x Custom Width/Depth	X	X	X	X	X
	Classic	5' x Custom Width/Depth	X	X	X	X	X
	Curved	5' x Custom Width/Depth	X	X	X	X	X
	Straight	5' x Custom Width/Depth	X	X	X	X	X
	Wave	5' x Custom Width/Depth	X	X	X	X	X
	Winged	5' x Custom Width/Depth	X	X	X	X	X
	Classic	5.5' x Custom Width/Depth	X	X	X		
	Straight	5.5' x Custom Width/Depth	X	X	X	X	X
	Winged	5.5' x Custom Width/Depth	X	X	X		

NOTE: For two-walled tub installations use the Tub Cap trim. Available in all standard colors. See page 90.

# CUSTOM-FITTED ACRYLIC BATHTUB LINERS

Our distinctive line of custom bathtub liners can be the perfect choice for your next bathroom remodeling project.

- Available in: White, Almond, Biscuit, Gray and Sandbar
- Constructed from DR-ABS acrylic
- Available in 4', 4.5', 5' and 5.5' Tubs
- Size varies per measurement of existing tub

**NOTE: 12 Key dimensions and a minimum of 2 descriptive photographs are required to identify tub style. Please check measurement form prior to placing an order.**

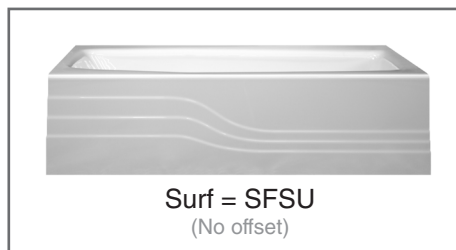







# ***WALK-IN & WALK-THRU TUBS***





## WALK-IN AND WALK-THRU TUB COLOR MATRIX

PRODUCT STYLES		DIMENSIONS	COLORS	
			White	Biscuit
WALK-IN TUBS	LA-3053 Alexis	53" x 29.875" x 37.5"	X	X
	LA-3060 Buckingham	60" x 30" x 36"	X	X
	LA-3052 Geneva	53" x 29.75" x 37.5"	X	X
	LA-2848 Grove	47.5" x 28" x 40"	X	X
	LA-3252W Lincoln	51.5" x 31.75" x 40.25"	X	X
	LA-3052W Zurich	52" x 29.75" x 40.5"	X	X
WALK-THRU INSERT	Small	Maximum Rail 4.75"	X	
	Medium	Maximum Rail 5.75"	X	
	Large	Maximum Rail 7.75"	X	

## LIQUID ACCENTS 3053 ALEXIS WALK-IN TUB

# the Alexis

## Walk-in Bathtub

With the Alexis Walk-In Bathtub, bathing at home is effortless, safe and soothing.

- Available in: White and Biscuit
- 67 Gallon capacity, 1.5 HP water pump, 1000 W air blower, 1500 W in-line heater
- Designed to fit through any doorway 30" or larger
- Constructed from durable Gel Coat
- 17" H x 24" W ADA-Compliant seat
- 10 Water jets massage the body to relieve aches and pains
- 18 Air spa jets release thousands of tiny bubbles creating a caressing massage
- Chromatherapy, aromatherapy and ozonator
- Bath bead sachet bags available for purchase in lavender, eucalyptus and jasmine.
- Dimensions: 53" W x 37.5" H x 29.875" D

***In Stock***

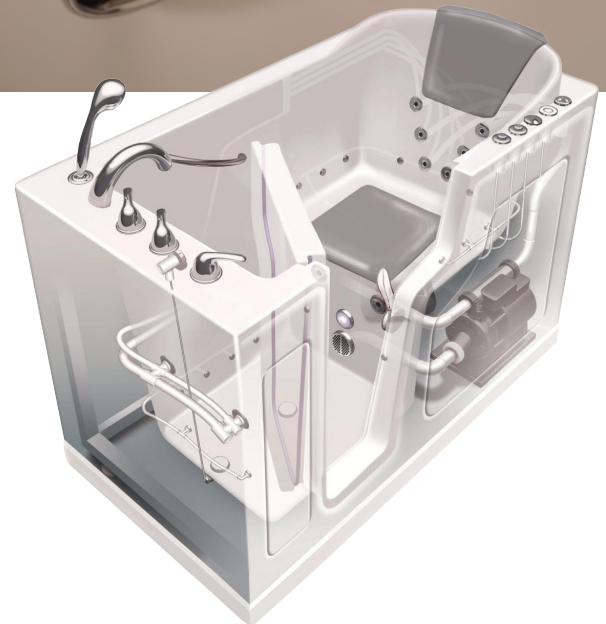



## ALEXIS WALK-IN TUB THERAPIES

### Standard Therapies on your Alexis Walk-in Tub

- Hydrotherapy jet massage has 10 water jets that massage and relax the body
- Air bubble therapy with 18 air spa jets release thousands of tiny bubbles creating a gentle caressing massage
- Color chromatherapy uses colored lights in water to improve one's mood and enhances relaxation
- Aromatherapy sachet bags are available to enhance your bathing experience
- Ozone therapy and purification aids in healing skin conditions



10 Water Jets



18 Air Jets



Therapy Controls



Aromatherapy Sachet Bags



# LIQUID ACCENTS 3060 BUCKINGHAM WALK-IN TUB

A tub that provides comfort with its extra wide seat and ample room to stretch your legs.

- Available in: White and Biscuit
- Marine-Grade Fiberglass & Resin Composite Tub Shell
- High-Gloss, Triple-Coated Gel Coat Finish
- One-Piece, Stainless-Steel Support Frame
- 6 Adjustable Leveling Legs
- Low, 6" Door Threshold
- Ergonomic, Push/Pull Door Handle
- Water-Tight Door Seal
- Inward Swinging Door
- 17" High, ADA-Compliant, Contoured Seat
- Neck Pillow
- Dimensions: 30" W x 60" L x 36" H
- Right or Left Hand Option

**\*Special Order**



**B3060 - TOP VIEW**

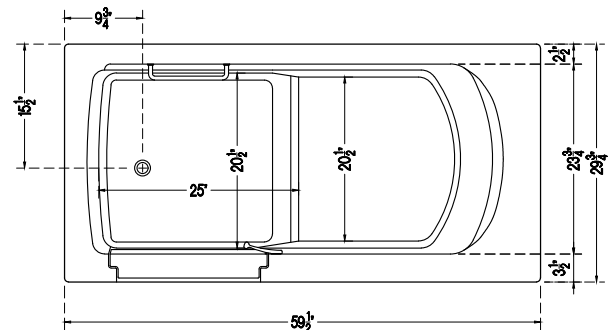

**B3060 - SIDE VIEW**

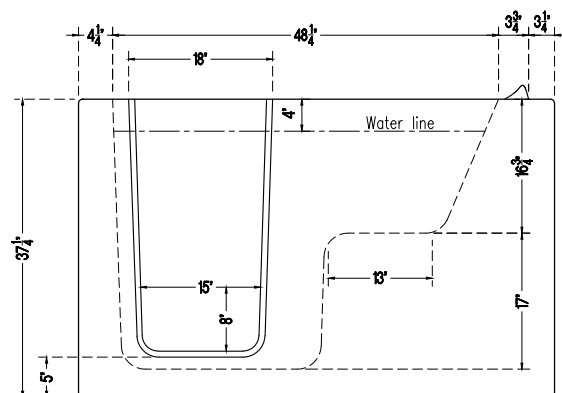

## LIQUID ACCENTS 3052 GENEVA WALK-IN TUB

Boasting a high tub basin, this tub allows for deeper upper body water immersion while maintaining a compact footprint.

- Available in: White and Biscuit
- Marine-Grade Fiberglass & Resin Composite Tub Shell
- High-Gloss, Triple-Coated Gel Coat Finish
- One-Piece, Stainless-Steel Support Frame
- 6 Adjustable Leveling Legs
- Low, 6" Door Threshold
- Ergonomic, Push/Pull Door Handle
- Water-Tight Door Seal
- Inward Swinging Door
- 17" High, ADA-Compliant, Contoured Seat
- Neck Pillow
- Dimensions: 29  $\frac{3}{4}$ " W x 53" L x 37  $\frac{1}{2}$ " H
- Right or Left Hand Option

**\*Special Order**



**3052-S - TOP VIEW**

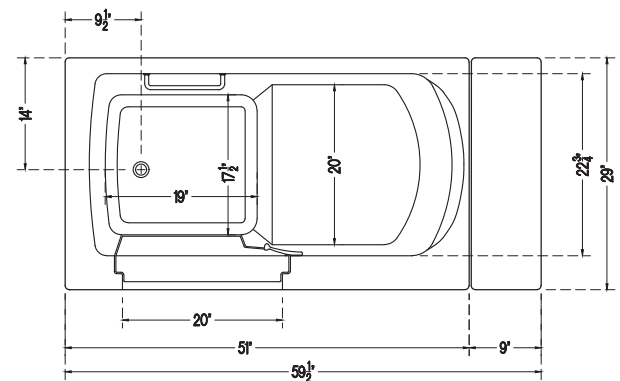

**3052-S - SIDE VIEW**

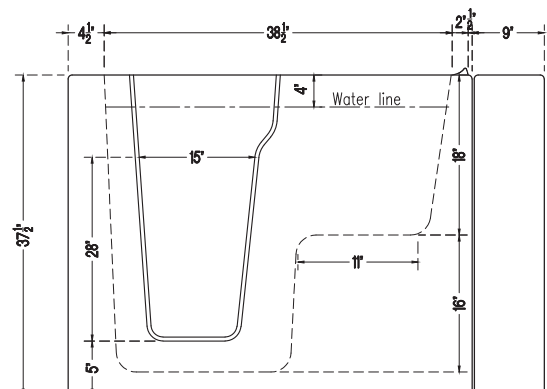



## LIQUID ACCENTS 2848 GROVE WALK-IN TUB

With its unique space-saving design, this compact tub allows for easy maneuverability through narrow doorways and hallways.

- Available in: White and Biscuit
- Marine-Grade Fiberglass & Resin Composite Tub Shell
- High-Gloss, Triple-Coated Gel Coat Finish
- One-Piece, Stainless-Steel Support Frame
- 6 Adjustable Leveling Legs
- Low, 6" Door Threshold
- Ergonomic, Push/Pull Door Handle
- Water-Tight Door Seal
- Inward Swinging Door
- 17" High, Contoured Seat
- Neck Pillow
- Dimensions: 28" W x 47 ½" L x 40" H
- Right or Left Hand Option

**\*Special Order**



2848 - TOP VIEW

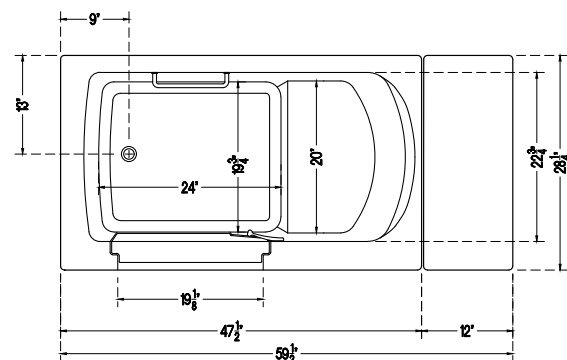

2848 - SIDE VIEW

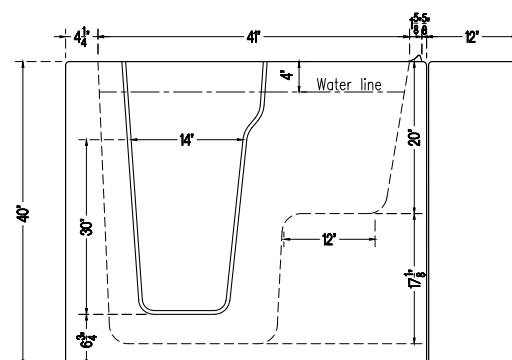

## LIQUID ACCENTS 3252W LINCOLN WALK-IN TUB

The extra-wide outward-swinging door is the highlight of this slide-in or transfer seat walk-in tub design allowing for worry-free, easy access.

- Available in: White and Biscuit
- Marine-Grade Fiberglass & Resin Composite Tub Shell
- High-Gloss, Triple-Coated Gel Coat Finish
- One-Piece, Stainless-Steel Support Frame
- 6 Adjustable Leveling Legs
- Low, 6" Door Threshold
- Ergonomic, Push/Pull Door Handle
- Water-Tight Door Seal
- 17" High, ADA-Compliant, Contoured Seat
- Neck Pillow
- Dimensions: 31 ¾" W x 51 ½" L x 40 ¼" H
- Right or Left Hand Option

**\*Special Order**



**3252W - TOP VIEW**

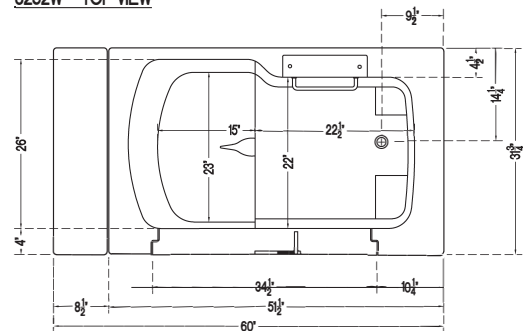

**3252W - SIDE VIEW**

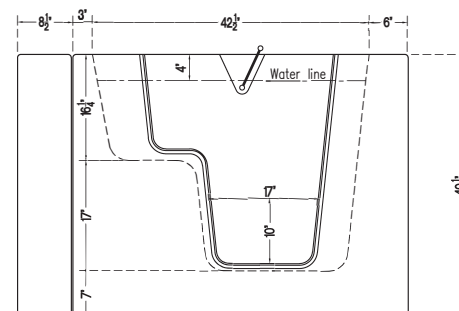

# LIQUID ACCENTS 3052W ZURICH WALK-IN TUB

This tub represents an ambitious balance of accessibility, compactness, and functionality.

- Available in: White and Biscuit
- Marine-Grade Fiberglass & Resin Composite Tub Shell
- High-Gloss, Triple-Coated Gel Coat Finish
- One-Piece, Stainless-Steel Support Frame
- 6 Adjustable Leveling Legs
- Low, 6" Door Threshold
- Ergonomic, Push/Pull Door Handle
- Water-Tight Door Seal
- Outward Swinging Door
- 17" High, ADA-Compliant, Contoured Seat
- Neck Pillow
- Dimensions: 29  $\frac{3}{4}$ " W x 52" L x 40  $\frac{1}{4}$ " H
- Right or Left Hand Option

**\*Special Order**



**3052W - TOP VIEW**

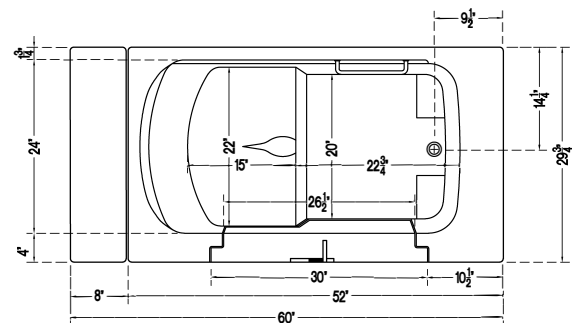

**3052W- SIDE VIEW**

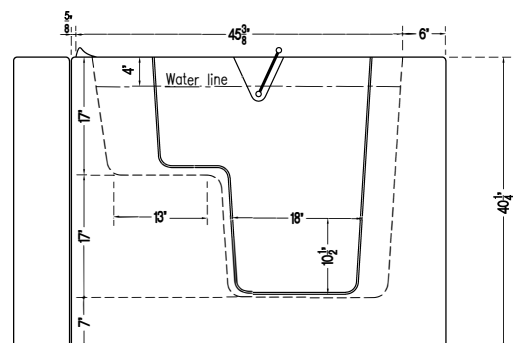



## WALK-IN TUB RAIN SHOWER KIT

Slide bar hand shower adjusts to optimum bather height.

- Chrome-plated stainless steel construction
- 28" length slider bar range
- 4 sleeve mount brackets. (Two 1.5" long brackets for plumbing from the extension panel - BCI recommended installation. Plus, two 2.5" long brackets for plumbing from the tub deck.)
- Chrome rain showerhead
- Chrome diverter included
- Hose length = 60"
- Depth: Rain Showerhead to wall distance = 17.5"
- Height from deck top to top of rain shower extension = 42"
- Height from floor to top of rain shower arm = 77"



## LIQUID ACCENTS WALK-IN TUB SHOWER CURTAIN

The ideal accessory for your new Walk-in Bathtub Shower Trim Kit.

- Curtain height is specially designed for walk-in bathtubs
- Metal grommets (Rod and rings sold separately)  
Rings available in Brushed Nickel, Stainless Steel and Oil Rubbed Bronze
- Durable semi-obscured, vinyl material
- Can be used with any walk-in tub
- Dimensions: 60" x 48"



## WALK-IN TUB HAND HELD SHOWERHEAD

The digital hand-held showerhead features a sleek design and the light changes with temperature variations.

- Wand color indicates water temperature.  
Built-in water (hydro) power, no battery, light changes with temperature!
- Water temperature <90°F = **BLUE LIGHT**  
Water temperature 90° - 108°F = **GREEN LIGHT**  
Water temperature 108° - 122°F = **RED LIGHT**  
Water temperature >122°F = **FLASHING RED LIGHT**



## WALK-IN TUB BASEBOARD TRIM

Finish your walk-in tub installation with our color-matched baseboard trim

- Available in White or Biscuit
- Dimensions: 59 3/4" x 4 1/4"

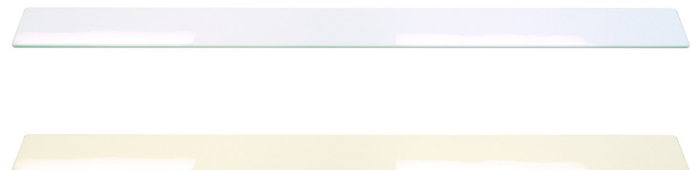

## WALK-THRU INSERT

Add safety and convenience to your existing bathtub with this simple insert that converts your tub into a low-barrier shower.

- An affordable solution that is convenient, adds easy access and added safety
- Reduce the possibility of hazardous falls when getting in and out of the tub
- Simple to install, requires no major demolition
- Kit Includes:  
Cap, Epoxy and Instruction
- Available in White only
- Dimensions:  
SMALL - Maximum Rail 4  $\frac{3}{4}$ "  
MEDIUM - Maximum Rail 5  $\frac{3}{4}$ "  
LARGE - Maximum Rail 7  $\frac{3}{4}$ "
- Walk-Thru Cutting template  
SMALL  
MEDIUM  
LARGE  
SET OF ALL 3
- Optional Quicktub accessory converts the unit back to a tub



**NOTE: QuickTub is only available in SMALL and MEDIUM sizes**



# ***BATHTUB DRAINS***



## BATHTUB DRAINS AND ADAPTERS

**220 1.375-16 DRAIN**  
**220 DRAIN WITH OVERFLOW**  
**301 1.6-16 DRAIN**  
**301 DRAIN WITH OVERFLOW**  
**301 WIDE FLANGE DRAIN**  
**305 1.865-11.5 DRAIN**  
**305 DRAIN WITH OVERFLOW**  
**305 WIDE FLANGE DRAIN**  
**309 1.625-14 DRAIN**  
**309 WIDE FLANGE DRAIN**



### BRASS ADAPTER ORDER INFORMATION:

#### AD-?

- 1 Converts from 1.6"-16 to 1.865"-11 1/2 - A1 (Green)
- 2 Converts from 1.6"-16 to 1.8"-14 - A2 (Blue)
- 3 Converts from 1.6"-16 to 1.8"-16 - A3 (Red)
- 4 Converts from 1.6"-16 to 1.9"-14 - A4 (Orange)
- 5 Converts from 1.865"- 11 1/2 to 2.11"-16 - A5 (Purple)
- 6 Converts from 1.865"- 11 1/2 to 2.30"-11 1/2 - A6 (Pink)
- 7 Converts from 1.6"-16 to 1.735"-16 - A7 (Lt. Blue)
- 8 Converts from 1.6"-16 to 1.865"-16- A8 (Lt. Green)
- 9 Converts from 1.6"-16 to 1.75"-12 - A9 (Brown)
- 10 Converts from 1.6"-16 to 1.865"-14 - A10 (Silver)
- 11 Converts from 1.375"-16 to 1.625"-16 - A11 (White)
- 12 Converts from 1.375"-16 to 1.625"-14 - A12 (Yellow)
- 13 Converts from 1.375"-16 to 1.813"-14 - A13 (Black & White)
- 14 Converts from 1.375"-16 to 1.75"-12 - A14 (Black)
- 15 Converts from 1.865"-11 1/2 to 2.00"-16 - A15 (Red & Blue)
- 16 Converts from 1.375"-16 to 1.6615"-18 - A16 (Orange & Purple)

**DR-ID-KIT** Drain Adapter Identification Kit



**DRAIN ADAPTER ID KIT**



**BRASS ADAPTER**

# WASTE AND OVERFLOW KITS



**OVERFLOW COVER  
(SHOWN IN CHROME)**



**OVERFLOW TUBE**



**OVERFLOW GASKET**



**BATHTUB DRAIN**



**ART FLEX OVERFLOW  
TUBE**

## OVERFLOW COVER ORDER INFORMATION: (KIT INCLUDES PLATE, CROSSBAR & SCREW)

OF-?

<b>C</b>	Chrome
<b>W</b>	White
<b>A</b>	Almond
<b>P</b>	Polished Brass
<b>BN</b>	Brushed Nickel
<b>ORB</b>	Oil Rubbed Bronze

## OVERFLOW GASKET ORDER INFORMATION:

OF-GKT

## OVERFLOW TUBE ORDER INFORMATION:

OF-GKT-TUBE

Black Only

## FLEXIBLE WASTE OVERFLOW TUBE ORDER INFORMATION:

DR-FLXWASTE-?

<b>C</b>	Chrome
<b>BN</b>	Brushed Nickel
<b>ORB</b>	Oil Rubbed Bronze

## INNOVATOR WASTE & OVERFLOW ORDER INFORMATION:

DR-INNWASTE-?

<b>C</b>	Chrome
<b>BN</b>	Brushed Nickel
<b>ORB</b>	Oil Rubbed Bronze







# **STANDARD SIZE ACRYLIC REPLACEMENT SHOWER BASES**





## STANDARD SIZE ACRYLIC REPLACEMENT SHOWER BASE MATRIX

PRODUCT STYLES	DIMENSIONS	COLORS				
		White	Almond	Biscuit	Gray	Sandbar
SINGLE THRESHOLD SHOWER BASES	32" x 32"	X	X	X	X	X
	36" x 36"	X	X	X	X	X
	48" x 32"	X	X	X	X	X
	48" x 34"	X	X	X	X	X
	60" x 30"	X	X	X	X	X
	60" x 32"	X	X	X	X	X
	60" x 34"	X	X	X	X	X
	60" x 36"	X	X	X	X	X
END DRAIN STANDARD SHOWER BASES	60" x 30" L/R	X	X	X	X	X
	60" x 32" L/R	X	X	X	X	X
SLIP RESISTANT BOTTOM	60" x 36"	X	X	X	X	X
	60" x 100"	X	X	X	X	X



## STANDARD SIZE ACRYLIC REPLACEMENT SHOWER BASE

In as little as one day, Prime Baths can replace your high-sided tub with an easy access beautiful shower.

- Installer friendly
- All BCI-manufactured bases are water tested for superior drainage
- Fiberglass reinforced for maximum support and sound deadening
- Dimensions: From 30" to 60"

***NOTE: All fiberglass-backed shower bases should be set in a bed of mortar***













# ***CUSTOM ACRYLIC SHOWER BASES***

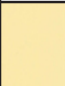

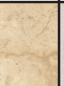

# CUSTOM ACRYLIC SHOWER BASE MATRIX

PRODUCT	WIDTH & HEIGHT	COLORS											
		White	Almond	Biscuit	Gray	Sandbar	Arctic Ice	Canyon Rock (M)	Sandalwood	Santa Cruz Granite	Sierra Sand	Taffeta (M)	White Travertine
													
CUSTOM SHOWER BASE*	Up to 60"L & Up to 36"W	X	X	X	X	X	X	X	X	X	X	X	X
	Oversized Up to 72"L & Over 48"W	X	X	X	X	X	X	X	X	X	X	X	X
	Double Threshold	X	X	X	X	X	X	X	X	X	X	X	X
NEO-ANGLE SHOWER BASES	35" x 35"	X	X	X	X	X							
	38" x 38"	X	X	X	X	X							
FLAT BOTTOM SHOWER BASES	Up to 60"L & Up to 36"W	X	X	X	X	X	X	X	X	X	X	X	X
LOW-BARRIER SHOWER BASES	60" x 30" 60" x 32"	Inquire about available sizes and colors. Available in Acrylic and Gel Coat											

(M) = Matte Finish

**\*NOTE:** Item not in stock. Item is made to order.

## CUSTOM SHOWER BASES

In as little as one day, Prime Baths can replace your high-sided tub with an easy access beautiful shower.

- Foam reinforced for maximum support and sound deadening
- Constructed from DR-ABS acrylic
- Self leveling for easy installation
- All BCI-manufactured bases are water tested for superior drainage
- Dimensions:  
Up to 60" in Length and up to 36" in Width

**NOTE: Item not in stock. Item is made to order.**



## CUSTOM EXTRA LARGE SHOWER BASES

In as little as one day, Prime Baths can replace your high-sided tub with an easy access beautiful shower.

- Foam reinforced for maximum support and sound deadening
- Center drain only
- Constructed from DR-ABS acrylic
- Self leveling for easy installation
- All BCI-manufactured bases are water tested for superior drainage
- Dimensions:  
Over 60" in Length or over 36" in Width
- Largest size available 72" x 48"

**NOTE: Item not in stock. Item is made to order.**



## CUSTOM DOUBLE THRESHOLD SHOWER BASES

In as little as one day, Prime Baths can replace your high-sided tub with an easy access beautiful shower.

- Foam reinforced for maximum support and sound deadening
- Center drain only
- Constructed from DR-ABS acrylic
- Self leveling for easy installation
- All BCI-manufactured bases are water tested for superior drainage
- Dimensions:  
Up to 60" in Length and up to 46" in Width

**NOTE: Item not in stock. Item is made to order.**



## CUSTOM BENT THRESHOLD

Flawlessly get the same color match over your tile threshold.

- Manufactured out of tub material
- Installation is comparable to the slip resistant bottom
- Available in White, Almond, Biscuit, Gray and Sandbar
- Made to order widths
- Dimensions: Up to 69" long





## NEO-ANGLE ACRYLIC REPLACEMENT SHOWER BASE

The Neo-Angle shower fits neatly into corners to save space.

- Spray foam reinforced for maximum support and sound deadening
- Available in White, Almond, Biscuit, Gray, and Sandbar
- Installer friendly
- All bases are water tested for superior drainage
- Dimensions: 38" x 38" and 35" x 35"
- Center drain

**NOTE: Item not in stock. Item is made to order.**



## LOW-BARRIER SHOWER BASE

Shower safely while remaining at home with a low-barrier shower base.

- Available in all solid and premium colors except Quartz
- Molded, one piece acrylic spray foam shower pan
- Available in left and right end drain
- Can be used with optional ramp
- Can accommodate all shower doors
- Optional rubber water dam available
- Dimensions:  
60" x 30" and 60" x 32"

**NOTE: Not available in Quartz**

**NOTE: Item not in stock. Item is made to order.**



## FLAT SLIP RESISTANT BOTTOM

A safe and reliable textured pattern that provides a slip-resistant shower floor.

- Dimensions:
  1. 59.5"L x 47.75" W x 0.120"
  2. 60"L x 94"W x 0.120" (at additional charge)

**NOTE:** Not available in Quartz



## FLAT SLIP-RESISTANT BOTTOM KIT

A safe and reliable textured pattern that provides a slip-resistant shower floor.  
Available as a kit.

- Available with:
  - (1) Flat Shower Floor
  - (1) 5 oz. Tube of #16 Cement
  - (1) Quick connect drain
  - (7) Tubes of Supertach
- Dimensions:
  1. 59.5"L x 47.75" W x 0.120"
  2. 60"L x 94"W x 0.120" (at additional charge)

**NOTE:** Not available in Quartz





# ***ACRYLIC SHOWER LINERS***





## ACRYLIC SHOWER LINERS

PRODUCT STYLES	DIMENSIONS	COLORS				
		White	Almond	Biscuit	Gray	Sandbar
SINGLE THRESHOLD SHOWER BASES	32" x 32"	X	X	X	X	X
	36" x 36"	X	X	X	X	X
	48" x 32"	X	X	X	X	X
	48" x 34"	X	X	X	X	X
	60" x 30"	X	X	X	X	X
	60" x 32"	X	X	X	X	X
	60" x 34"	X	X	X	X	X
	60" x 36"	X	X	X	X	X
CUSTOM THRESHOLD	69" Maximum	X	X	X	X	X



# ***SHOWER DRAINS***



## SHOWER DRAINS

Every Acrylic Replacement Shower Pan will require a new 2" drain.

- All Drains meet the Universal Plumbing Code
- PVC and Brass Drains available
- Standard Sizes means a guaranteed fit every time
- Not included with shower bases.  
Drains must be ordered with each shower base.



**2" PVC REPLACEMENT  
SHOWER BASE DRAIN  
(SHOWN IN CHROME)**



**2" BRASS REPLACEMENT  
SHOWER BASE DRAIN  
(SHOWN IN CHROME)**



**DRAIN SHOE ASSEMBLY**



**SHOWER DRAIN GRID  
COVER (SHOWN IN  
POLISHED BRASS)**

### SHOWER PAN DRAIN (SNAP-IN COVER) ORDER INFORMATION:

**DR-SL-?**

**C** Chrome

### 2" BRASS REPLACEMENT SHOWER BASE DRAIN ORDER INFORMATION:

**DR-RBB-2**

Chrome with Brass Base

### 2" PVC REPLACEMENT SHOWER BASE DRAIN ORDER INFORMATION:

**DR-RB-2**

Chrome with PVC Base

### SHOWER BASE DRAIN GRID COVER (SNAP ON) ORDER INFORMATION:

**DR-CRV-4-?**

**C** Chrome  
**P** Polished Brass  
**BN** Brushed Nickel  
**ORB** Oil Rubbed Bronze



**DRAIN FORMING TOOL**

### DRAIN SHOE ASSEMBLY ORDER INFORMATION:

**DR-DRAINSHOE**

### DRAIN FORMING TOOL ORDER INFORMATION:

**DR-FORMING TOOL**



# ***ACRYLIC WALL SURROUNDS***



# ACRYLIC WALL MATRIX

	PRODUCT	WIDTH & HEIGHT	COLORS													
			White	Almond	Biscuit	Gray	Sandbar	Matte White (M)	Arctic Ice	Canyon Rock (M)	Quartz	Sandalwood	Santa Cruz Granite	Sierra Sand (M)	Taffeta (M)	White Travertine
MID-WALL TRIMS																
	Stocked Items															
	SILICONE TUBE COLOR	N/A	W	SC	SC	G	SC	W	G3*	T	G3*	AT	GR	T	G2*	AT
	SMOOTH Can be bent into 3/4 System.	38" x 65"	✓	✓	✓	✓	✓	✓	✓	✓	✓	✓	✓	✓	✓	✓
		40" x 98.5"	✓	✓	✓	✓	✓	✓	✓	✓	✓	✓	✓	✓	✓	✓
		61" x 85"	✓	✓	✓	⊘	⊘	⊘	⊘	⊘	⊘	⊘	⊘	⊘	⊘	⊘
		65" x 98.5"	✓	✓	✓	✓	✓	✓	✓	✓	✓	✓	✓	✓	✓	✓
	MESA VERDE	95" x 5"	✓	✓	✓	✓	✓	⊘	⊘	✓	⊘	✓	⊘	✓	⊘	✓
	PUEBLO	95" x 5"	✓	✓	✓	✓	✓	⊘	✓	✓	⊘	✓	✓	✓	✓	✓
	SANTA FE LISTELLO	80" x 5"	✓	✓	✓	✓	✓	⊘	✓	✓	⊘	✓	✓	✓	✓	✓
	Non-Stocked Items															
	WAINSCOT WALLS	59" x 97.5"	✓	✓	✓	✓	✓	✓	✓	✓	⊘	✓	✓	✓	✓	✓
	4"X4" TILE	36" x 98"	Sim-Tile walls are available in all Prime Baths colors.													
	8"X8" TILE	60" x 98"														
	SUBWAY TILE	60" x 98"														
	PIAZZA TILE	60" x 98"														
	10"X10" ROSETTES	60" x 98"														
	12"X12" ROMA	35" x 98"														
		60" x 98"														
	SCALLOPED ACCENT WALLS	60" x 98.5"	Scalloped Accent Walls are available in Matte White only.													

**KEY:** SILICONE COLOR: AT=Almond Translucent G=Gray GR=Granite SC=Same as Wall Color T=Translucent W=White

\*G3 = Matching silicone color. Dealers may also use *Gray Translucent* for these options.

✓ = Item is available ⊘=Not Available (M)=Matte Finish 38"x65"=Ceiling Panel

\*Colors may appear different than shown. Product & color availability is subject to change.

© BCI. PRIMEWM 03\_24 V1

# BATH/SHOWER FLAT WALL SYSTEM SIZES

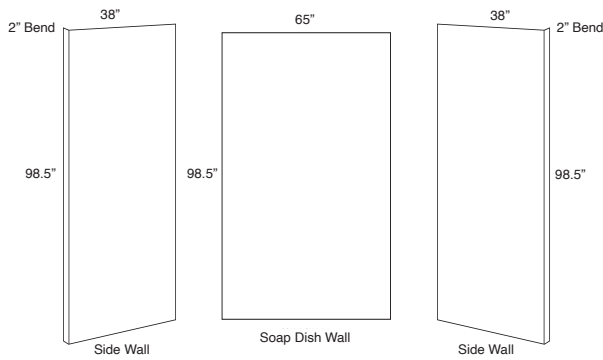

## SHOWER SYSTEMS

- (2) Side walls - 40" x 98.5" includes 2" bend on side
- (1) Soap dish wall - 65" x 98.5" flat

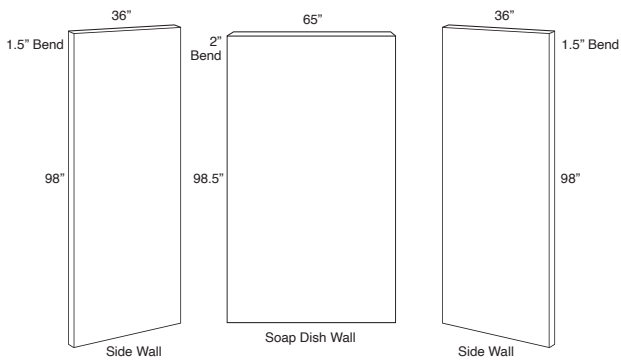

## TALL 'A' SYSTEM OR 3/4 SYSTEM FOR SHOWERS

- (2) Side wall - 36" x 98" + 1.5" bend on all four sides
- (1) Soap dish wall - 65" x 98.5" w/ 2" bend on top

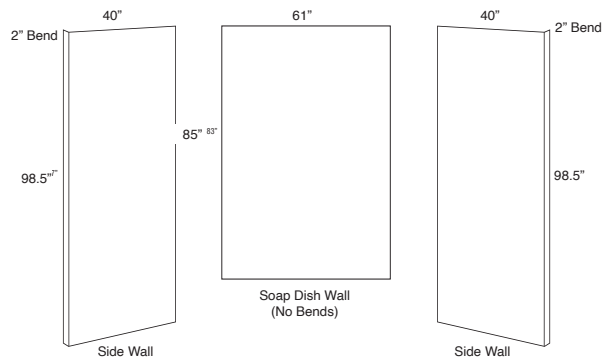

## TUB SYSTEMS

- (2) Side walls - 40" x 98.5" includes 2" bend on side
- (1) Soap dish wall - 61" x 85" flat

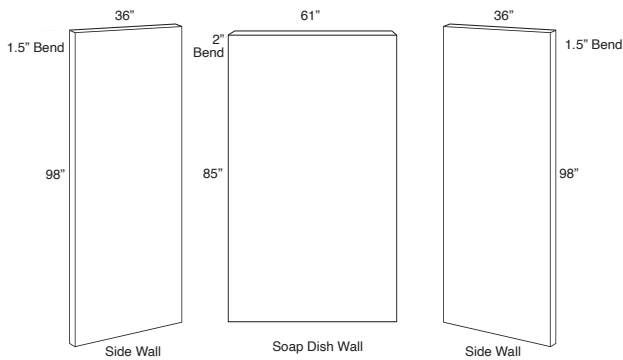

## 'A' SYSTEM OR 3/4 SYSTEM FOR TUBS

- (2) Side wall - 36" x 98" + 1.5" bend on all four sides
- (1) Soap dish wall - 61" x 85" w/ 2" bend on top



# BATH/SHOWER SIMULATED TILE WALL SYSTEMS

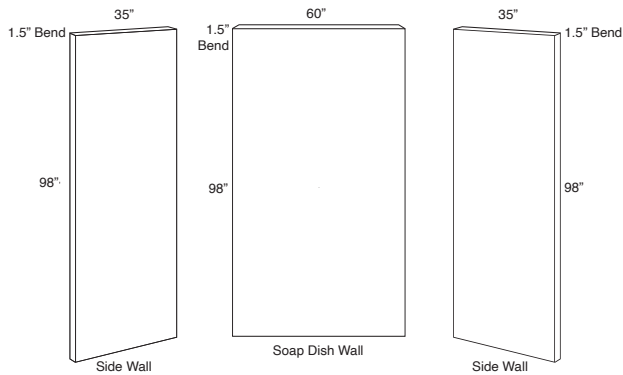

## 4" X 4" TILE SHOWER SYSTEM

## 8" X 8" TILE SHOWER SYSTEM

## 12" X 12" TILE SHOWER SYSTEM

(2) Side walls - 35" x 98" + 1.5" bends on all four sides

(1) Soap dish wall - 60" x 98" + 1.5" bends on all four sides

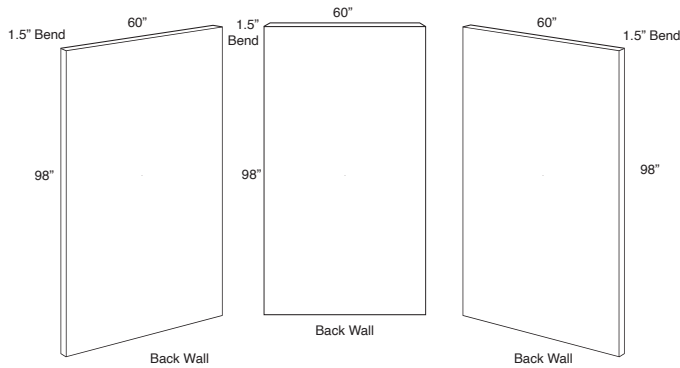

## 10" X 10" TILE SHOWER SYSTEMS

## PIAZZA TILE SHOWER SYSTEMS

## SUBWAY TILE SHOWER SYSTEMS

(3) Back Walls - 60" x 98" + 1.5" bends on all four sides

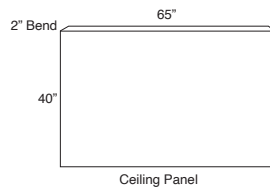

## CEILING PANEL

Ceiling panels are 40" x 65" + 2" bend on 65" side

\*TIP: When ordering a special bend please include a sketch showing the detail of the bend with the finished dimensions on the sketch.

## SMOOTH WALL

Get the chic and clean look of a smooth wall system.

- Color coordinates with all of solid color accessories
- Constructed from DR-ABS acrylic
- Dimensions:
  - Solid Colors (White, Almond and Biscuit)
    - Side wall - 40" W x 98.5" H
    - Tub soap dish wall - 61" W x 85" H
    - Shower soap dish wall - 65" W x 98.5" H
    - Ceiling Panel - 40" W x 65" H
  - Premium Colors
    - Side wall - 40" W x 98.5" H
    - Soap dish wall - 65" W x 98.5" H
  - Special Bend\*\*:
    - Neo-Angle, Two-Wall Shower Systems, Two-Wall Tub Systems, and Wainscoting can be accommodated by using individual walls to fit specific applications.



**SMOOTH WALL SHOWER SHOWN WITH CORNER SEAT**

## 4" x 4" TILE PATTERN

A smooth texture with a traditional look.

- Available in multiple colors
- Constructed from DR-ABS acrylic
- Dimensions:
  - Side wall - 35" W x 98.5" H
  - Soap dish wall - 60" W x 98" H



## TEXTURED 8" x 8" TILE PATTERN

The simple and classic 8" x 8" designer trend look.

- The look and feel of real ceramic tile
- Constructed from DR-ABS acrylic
- Dimensions  
Side wall - 35"W x 98.5"H  
Soap dish wall - 60"W x 98.5"H



## SUBWAY TILE PATTERN

Trendy yet classic, the designer Subway pattern adds an extra touch of excitement.

- Smooth ceramic-like finish
- Constructed from DR-ABS acrylic
- Dimensions:  
**Soap dish wall (only) - 60"W x 98.25"H**





## 10" x 10" TILE WITH ROSETTES

A simplistic smooth tile pattern with a decorative rosette design.

- Pattern available in soap dish walls only
- Constructed from DR-ABS acrylic
- Dimensions:  
**Soap dish wall (only) - 60.25" W x 98.25" H**



## PIAZZA TEXTURED TILE PATTERN

Create your own urban escape with this trendy Piazza tile pattern with a textured finish.

- Installation Tip: May require an additional 6 cartridges of SuperTach® adhesive
- Constructed from DR-ABS acrylic
- Dimensions:  
**Soap dish wall (only) - 59.5" W x 97" H**



## ROMA TEXTURED 12" X 12" TILE PATTERN

Enjoy a bold and stylish tile pattern that will compliment any bathroom.

- Heavily textured to look like real Italian ceramic
- Constructed from DR-ABS acrylic
- Dimensions  
Side wall - 35"W x 98"H  
Soap dish wall - 60"W x 98"H



## WAINSCOT BEAD BOARD & TRIM

Tastefully protects your walls from knocks and splashes, wainscot bead board is also an eye-pleasing design element.

- Traditional beaded design
- Constructed from durable acrylic
- Dimensions:
  - Walls: 96"W x 58"H
  - Seam: 1.5"W x 58"H
  - Outside Corner: 2.25"W x 58"H
  - Inside Corner: 2.5"W x 58"H
- Integrated chair rail, one piece panel.





## MID-WALL & CAPPING TRIM

Add the final touch of elegance and design with these contemporary patterned wall trims.

- Smooth ceramic-like finish
- Constructed from durable ABS-backed acrylic
- Dimensions:
  - Mesa Verde: 95"L x 5"W
  - Pueblo: 95"L x 5"W
  - Santa Fe Listello: 80"L x 5"W
- Great for extending walls vertically
- Can be used as decorative mid-wall trim or capping trim
- Santa Fe Listello comes as a two pack
- Mesa Verde and Pueblo come as an individual trim

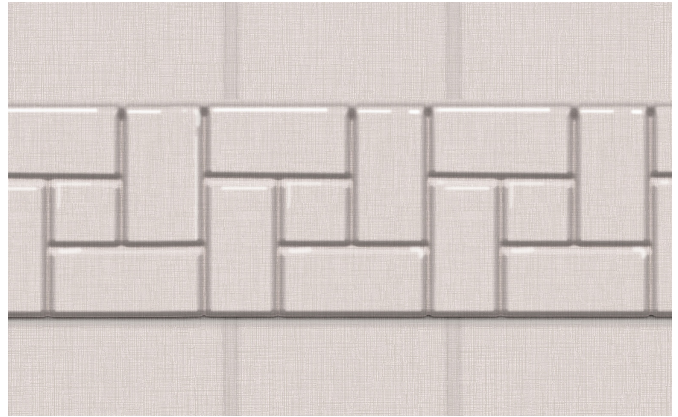

**MESA VERDE TRIM**



**PUEBLO TRIM**



**SANTA FE LISTELLO TRIM**

### AVAILABLE IN:













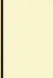

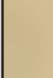
---

Refer to the Wall Matrix on page 43.

# ***ACRYLIC WALL ACCESSORIES & TRIM***



# ACRYLIC WALL ACCESSORIES AND TRIM MATRIX

PRODUCTS	COLORS													
	White	Almond	Biscuit	Gray	Sandbar	Matte White (M)	Arctic Ice	Canyon Rock (M)	Quartz	Sandalwood	Santa Cruz Granite	Sierra Sand (M)	Taffeta (M)	White Travertine
														
<b>SINGLE TIER SHELF</b>	X	X	X	X	X	X	X	X	X	X	X	X	X	X
<b>TOWER CADDY WITH FOOT REST</b>	X	X	X	X			X	X	X	X	X	X	X	X
<b>SURFACE SOAP DISH</b>	X	X	X	X	X		X	X	X	X		X	X	X
<b>SOAP DISH SHELF</b>	X	X	X				X	X	X	X	X	X	X	X
<b>4-SHELF CORNER CADDY</b>	X	X	X	X			X	X	X	X	X	X	X	X
<b>HEXAGON CORNER SEAT</b>	X	X	X	X	X		X	X	X	X	X	X	X	X
<b>SHOWER BENCH SEAT</b>	X	X	X	X	X		X	X	X	X	X	X	X	X
<b>WINDOW TRIM KIT</b>	X	X	X	X	X	X	X	X	X	X	X	X	X	X
<b>CORNER REINFORCEMENT</b>	X													
<b>OUTSIDE CORNER TRIM</b>	X	X	X	X	X		X	X	X	X	X	X	X	X
<b>INSIDE CORNER TRIM</b>	X	X	X	X	X		X	X	X	X	X	X	X	X
<b>CUSTOM BENT THRESHOLD</b>	X	X	X	X	X		X	X		X	X	X	X	X
<b>TUB CAP TRIM</b>	X	X	X	X	X									
<b>KNEE WALL LEDGE CAP – 1/2" THICK</b>	X	X	X											
<b>KNEE WALL LEDGE CAP – 3/4" THICK</b>	X	X	X	X	X		X	X		X	X	X	X	X
<b>HOLE CAP (4" &amp; 6")</b>	X	X	X	X			X	X	X	X	X	X	X	X

(M) = Matte Finish



# SINGLE TIER SHELF

Display all the essential extras  
that make the bathing experience complete.

- Can be easily installed at any desired height
- Add as many as you like to suit your needs
- Constructed from DR-ABS acrylic
- Available in every color
- Dimensions: 12.75"W x 1.75"H x 9"D

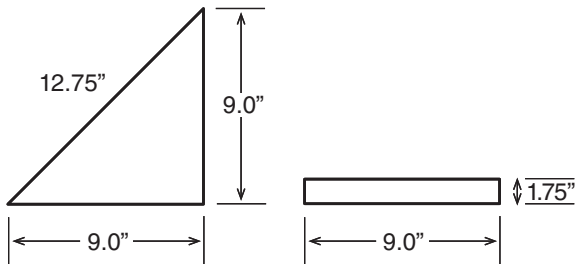

## AVAILABLE IN:

White  
Almond  
Biscuit  
Gray  
Sandbar

Matte White  
Arctic Ice  
Canyon Rock  
Quartz  
Sandalwood

Santa Cruz Granite  
Sierra Sand  
Taffeta  
White Travertine

## TOWER CADDY WITH SHAVING STAND

Our Tower Caddy provides the optimal level of storage for your entire family's bathing needs with an added shaving stand.

- Can be used over a tub or shower
- Built-in shaving stand for added comfort
- Constructed from durable acrylic
- Dimensions: 9.75" W x 98.5" H x 7"D

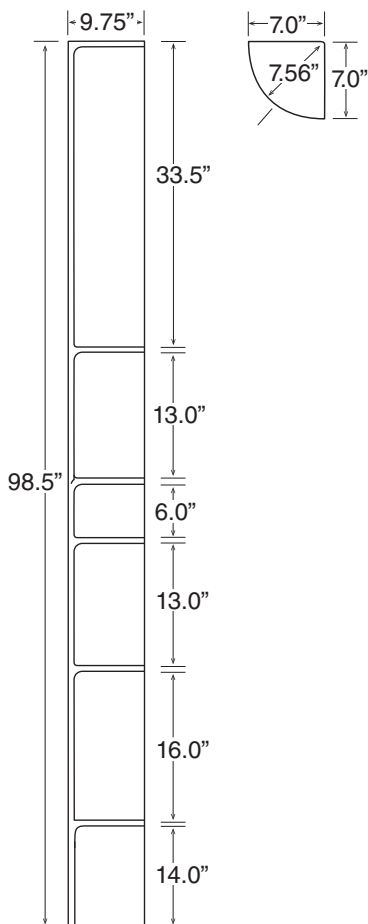

### AVAILABLE IN:

White  
Almond  
Biscuit  
Gray  
Arctic Ice

Canyon Rock  
Quartz  
Sandalwood  
Santa Cruz Granite  
Sierra Sand

Taffeta  
White Travertine

# SURFACE MOUNT SOAP DISH

Traditional and timeless, the surface mount soap dish is the perfect accessory.

- Installation tip: No need to cut holes in the soap dish wall
- Can be placed at any desired location within the bath enclosure
- Constructed from DR-ABS acrylic
- Dimensions: 6.875"W x 2.75"D x 5"H

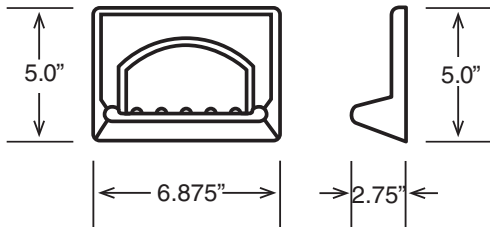

## AVAILABLE IN:

White  
Almond  
Biscuit  
Gray  
Sandbar

Arctic Ice  
Canyon Rock  
Quartz  
Sandalwood  
Santa Cruz Granite

Sierra Sand  
Taffeta  
White Travertine



## SOAP DISH SHELF

Display all the essential extras  
that make the bathing experience complete.

- Horizontal storage unit holds soap and other hygiene products
- Can be easily installed at any desired height
- Affordably priced
- Constructed from DR-ABS acrylic
- Dimensions: 29.75"W x 3.625"D x 4.75"H

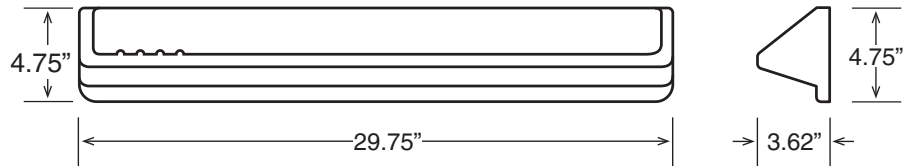

### AVAILABLE IN:

White  
Almond  
Biscuit  
Arctic Ice  
Canyon Rock

Quartz  
Sandalwood  
Santa Cruz Granite  
Sierra Sand  
Taffeta

White Travertine

## 4-SHELF CORNER CADDY

Our 4-Shelf Caddy provides the optimal level of storage for your entire family's bath needs.

- Can be used over a tub or shower
- 10" between shelves
- Constructed from DR-ABS acrylic
- Contains two ribbed shelves with drainage channels and two smooth shelves
- Dimensions: 9.5" W x 35" H x 7"D

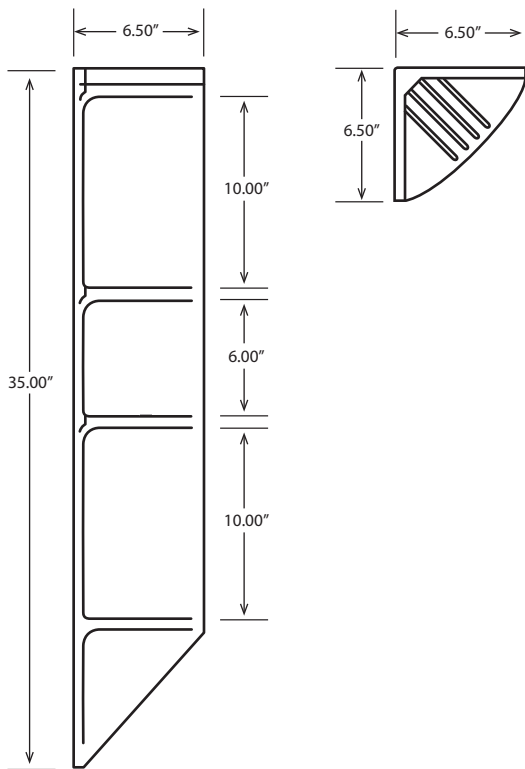

### AVAILABLE IN:

White  
Almond  
Biscuit  
Gray

Arctic Ice  
Canyon Rock  
Quartz  
Sandalwood

Santa Cruz Granite  
Sierra Sand  
Taffeta  
White Travertine

## CORNER HEXAGON SHOWER SEAT

Get the ultimate safety and protection with Prime Baths classic shower seat design.

- Heavyweight stainless steel bracket included
- Can support up to 900 lbs
- Built-in weep hole in back
- Concealed bracket installation
- Constructed from DR-ABS acrylic
- Backed with structural fiberglass
- Right or left hand applications
- Dimensions: 28" W x 20.25" D x 1.75" H

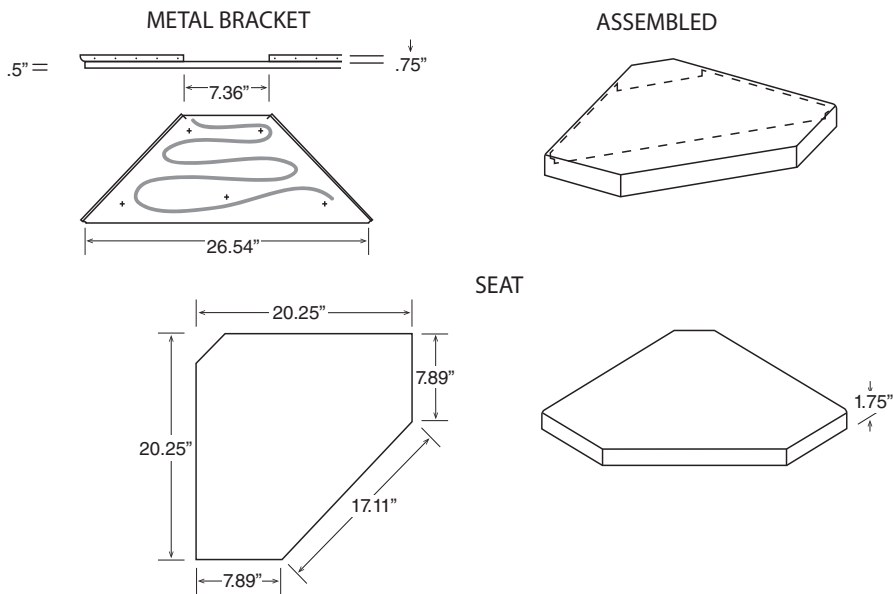

**CORNER SEAT**

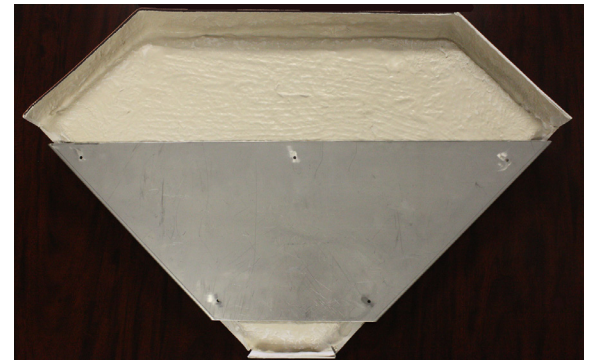

**UNDERSIDE OF CORNER SEAT**

### AVAILABLE IN:

White  
Almond  
Biscuit  
Gray  
Sandbar

Arctic Ice  
Canyon Rock  
Quartz  
Sandalwood  
Santa Cruz Granite

Sierra Sand  
Taffeta  
White Travertine



# SHOWER SEAT - BENCH

Get the ultimate safety and protection with Prime Baths bench shower seat design.

- Heavyweight stainless steel bracket included
- Can support up to 2,200 lbs
- Designed for bathers of all sizes
- Built-in weep hole in back
- Concealed bracket installation
- Constructed from DR-ABS acrylic
- Backed with structural fiberglass
- Dimensions: 26" W x 14" D x 2" H

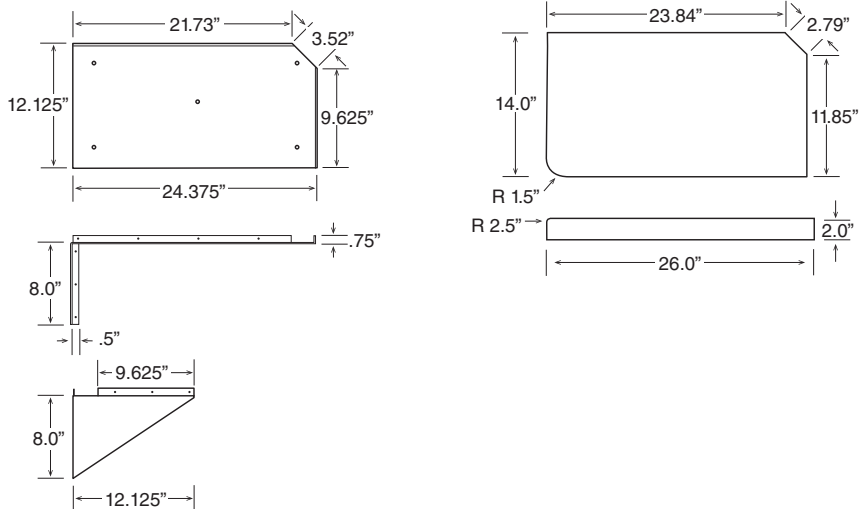

## AVAILABLE IN:

White  
Almond  
Biscuit  
Gray  
Sandbar

Arctic Ice  
Canyon Rock  
Quartz  
Sandalwood  
Santa Cruz Granite

Sierra Sand  
Taffeta  
White Travertine

## WINDOW KITS

A classic design that blends with any setting providing beautiful window treatment option.

- Contains a contemporary, decorative window trim
- Encases the window in maintenance-free acrylic
- Window Kit Dimensions: Four 48" lengths x 6" W



### AVAILABLE IN:

White  
Almond  
Biscuit  
Gray  
Sandbar

Matte White  
Arctic Ice  
Canyon Rock  
Quartz  
Sandalwood

Santa Cruz Granite  
Sierra Sand  
Taffeta  
White Travertine

## CORNER REINFORCEMENT

The corner reinforcement provides an additional barrier of protection against water penetration.

- Creates a 90° corner at every vertical joint
- 96" x 1.75" x 1.75"
- Should be installed with every wall system

*\*Not included in Install Kits (purchase separately)*

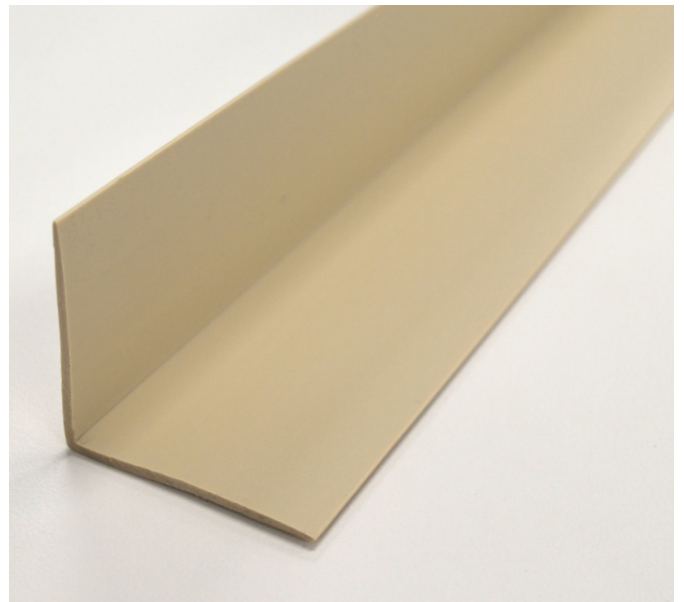
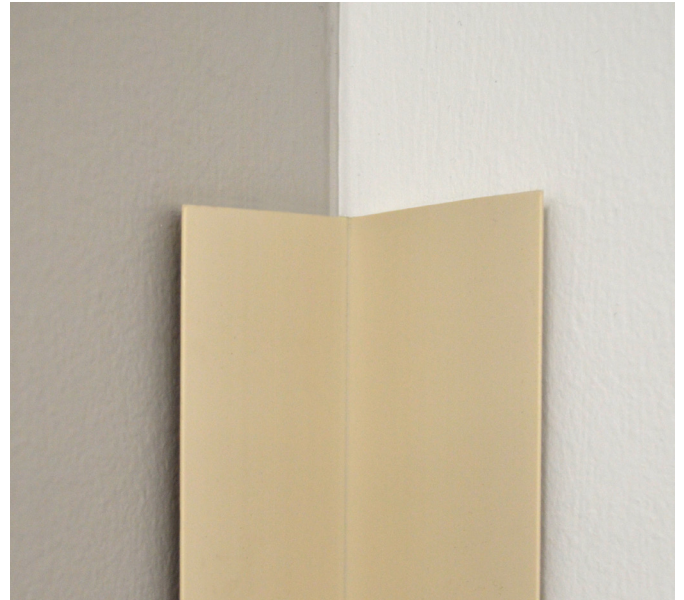



## INSIDE CORNER TRIM

Perfectly match your design wall with this high quality acrylic trim.

- Cover and protects corners and gaps
- Finished top edge for 3/4" systems
- Dimensions:  
96"W x 1 1/8" x 1 1/8"



## OUTSIDE CORNER TRIM

Flow seamlessly into the rest of your bathroom with this durable outside trim.

- Manufactured from actual wall material for an exact color match
- Rounded edge
- Dimensions:  
96"W x 1 1/8" x 1 1/8"  
96"W x 2" x 2"



### AVAILABLE IN:

White  
Almond  
Biscuit  
Gray  
Sandbar

Arctic Ice  
Canyon Rock  
Quartz  
Sandalwood  
Santa Cruz Granite

Sierra Sand  
Taffeta  
White Travertine

# TUB CAP TRIM

Finish off the look and enhance the flow of your bathroom with the tub cap trim.

- Acrylic trim piece used to join tub liner skirt with a panel on a two-wall tub
- Original Prime Baths Bath design
- Constructed from DR-ABS acrylic
- Available in White, Almond, Biscuit, Gray and Sandbar
- Dimensions: 18" x 4.25"



## AVAILABLE IN:

---

White  
Almond  
Biscuit  
Gray  
Sandbar

## KNEE WALL CAP TRIM

The Acrylic Knee Wall Cap can mount to any structurally sound substrate.

- Paintable surface on underside
- Reinforced backing
- Constructed from DR-ABS acrylic
- Sizes:

1/2" x 10" x 60"

1/2" x 6" x 40"

1/2" x 6" x 60"

3/4" x 6" x 40"

3/4" x 6" x 72"

- Limited Lifetime Warranty



### AVAILABLE IN:

White  
Almond  
Biscuit  
Gray  
Sandbar

Arctic Ice  
Canyon Rock  
Quartz  
Sandalwood  
Santa Cruz Granite

Sierra Sand  
Taffeta  
White Travertine



# HOLE CAP

Match your shower walls with a Hole Cap.

- Paintable surface on underside
- Constructed from durable DR-ABS acrylic
- Available in 4" and 6" in all Prime Baths colors except Matte White
- Limited Lifetime Warranty



**AVAILABLE IN:**

---

White	Arctic Ice	Sierra Sand
Almond	Canyon Rock	Taffeta
Biscuit	Quartz	White Travertine
Gray	Sandalwood	
Sandbar	Santa Cruz Granite	







# ***METAL ACCESSORIES AND FIXTURES***





## MOEN VERSO™ BRAND MAGNETIX REMOVEABLE SHOWERHEAD

The Verso showerheads include Moen's new Infiniti Dial technology that allows users to select several options with continuous pressure. Users slide the dial to blend sprays and pressure to their liking. It's a three-in-one design, enabling the two showerheads to run simultaneously or separately.

- Brushed Nickel, Chrome, and Matte Black
- 7" Diameter Showerhead
- Eight Total Spray Settings
- 1.75 gpm max, CA compliant
- 72" Metal Hose



# MOEN MAGNETIX HAND SHOWER

This aromatherapy hand shower is equipped with INLY technology, which infuses essential oils directly into your shower water. Allows you to control the dilution rate. For use with INLY capsules only (sold separately).

- Brushed Nickel, Chrome, and Matte Black
- 7" Diameter Showerhead
- Eight Total Spray Settings
- 1.75 gpm max, CA compliant
- 72" Metal Hose
- Capsules come in packages of 5



## LIQUID ACCENTS SIERRA SERIES SHOWERHEAD & MIXER VALVE

Awaken every morning to a refreshing shower with this sophisticated showerhead & mixer valve trim.

- Quality Fixtures for your Bath & Shower
- Available in Brushed Nickel, Chrome, Matte Black and Oil Rubbed Bronze
- 2.5 GPM (Gallons Per Minute)
- Four-function showerhead (Full spray, invigorating spray, massage, combination)



**SIERRA SERIES SHOWERHEAD & MIXER  
(SHOWN IN ORB)**

### THE PRIME BATHS BATH VALVE

Pressure-balanced valve helps maintain water temperature. Meets or exceeds plumbing codes. Built-in shut-off with single standardized cartridge design.



# LIQUID ACCENTS SIERRA SERIES SHOWERHEAD, MIXER VALVE & TUB KITS

Awaken every morning to a refreshing shower with this sophisticated shower head, mixer valve trim and tub kit.

- Quality Fixtures for your Bath & Shower
- Available in Brushed Nickel, Chrome and Oil Rubbed Bronze
- 2.5 GPM (Gallons Per Minute)
- Four-function showerhead (Full spray, invigorating spray, massage, combination)

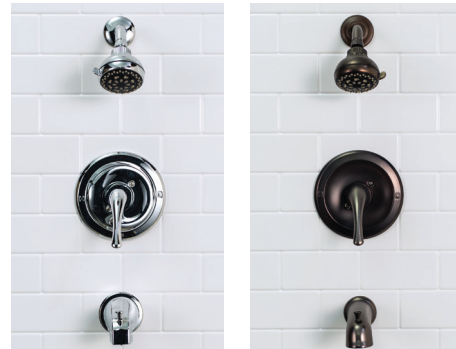
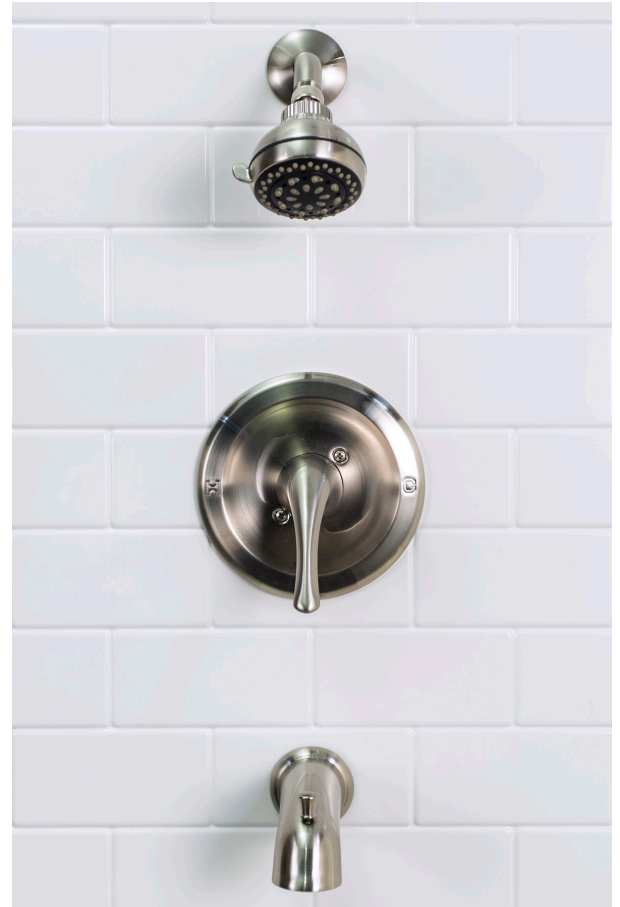

## THE PRIME BATHS BATH VALVE

Pressure-balanced valve helps maintain water temperature. Meets or exceeds plumbing codes. Built-in shut-off with single standardized cartridge design.

## LIQUID ACCENTS KENSINGTON SHOWERHEAD, MIXER VALVE & TUB KITS

Liquid Accents Kensington showerhead & mixer valve trim.

- Traditional style
- Shower and tub kits available
- Available in Chrome, Brushed Nickel, Matte Black and Oil Rubbed Bronze



# **LIQUID ACCENTS SEVILLE SHOWERHEAD, MIXER VALVE & TUB KITS**

Liquid Accents Seville showerhead & mixer valve trim.

- Shower and tub kits available
- Available in Chrome, Brushed Nickel, Matte Black and Oil Rubbed Bronze





## LIQUID ACCENTS HAND HELD SHOWERHEAD, WALL MOUNT, SLIDER BAR & DIVERTER VALVE

Focus on the areas you specifically wish to bathe with our hand-held showerhead.

- Quality Fixtures for your Bath & Shower
- 59" hose and shower arm bracket.
- Available in Brushed Nickel, Chrome, Matte Black and Oil Rubbed Bronze
- 2.5 GPM (Gallons Per Minute)

This adjustable mount attaches the hand-held showerhead to the wall when a slider bar is not used.

- Available in Brushed Nickel, Chrome, Matte Black and Oil Rubbed Bronze

Switch conveniently from standard shower head to hand-held with this slider bar & diverter valve.

- Quality Fixtures for your Bath & Shower
- Available in Polished Chrome, Brushed Nickel and Oil Rubbed Bronze
- Dimensions: 26"L

Order a diverter valve to move water to the hand-held showerhead.

- .5" female inlet and .5" male outlet by .5" hose outlet



## LIQUID ACCENTS RAIN SHOWERHEAD

Relax under this beautiful, stylish rain showerhead. A 13" "S" arm moves the rain showerhead away from the wall.

- Quality Fixtures for your Bath & Shower
- 8" Head
- 160 Clog-free, rubber nozzles
- 13" "S" shower arm
- Available in Brushed Nickel, Chrome, Matte Black and Oil Rubbed Bronze
- 2.5 GPM (Gallons Per Minute)



## DESIGNER GRAB BARS

Distinctively stylish and easy-to-install, Liquid Accents grab bars include the following features:

- Available in 12", 18", 24" and 36" sizes
- Available in Brushed Gold, Brushed Nickel, Chrome, Matte Black and Oil Rubbed Bronze
- Made of sturdy, steel construction\*
- More cost-effective price
- ADA Compliant
- Lifetime warranty on finish

\*Holds up to 500 lbs. Liquid Accents grab bars meet or exceed the applicable requirements of the following standards:  
ANSI A117.1, ASTM F446, CSA B45, CSA B651.



**LIQUID ACCENTS KENSINGTON GRAB BAR**



**LIQUID ACCENTS SEVILLE GRAB BAR**



## SHOWER VALVE GRAB BAR

This sleek, curved valve grab bar is designed to encircle tub or shower faucets, providing long-lasting security and support along with visual appeal.

- 1-1/4" Diameter x 18 Gauge, .048
- Made from 304 Stainless Steel
- Two threaded wall receivers (1/4" x 2" long) with brass inserts and exposed flanges (2-3/4" diameter x 12 gauge, .105)
- Welded End Caps
- Standard Size: 12" diameter ring with mounting posts at 10-3/4" centers
- Supports 250 lbs. when properly installed
- Available in Brushed Gold, Brushed Nickel, Chrome, Matte Black and Oil Rubbed Bronze



## CORNER GRAB BAR SHELF

Add Storage space and extra safety with this 2-in-1 Corner Grab Bar Shelf:

- Made of sturdy, rust-resistant 304 stainless steel
- Designed to fit any size wall
- Mounting stainless steel screws included
- Available in Brushed Gold, Brushed Nickel, Chrome, Matte Black, Oil Rubbed Bronze
- Dimensions: 10" x 10" (Shelf dimensions: 7" x 7")
- ADA Compliant

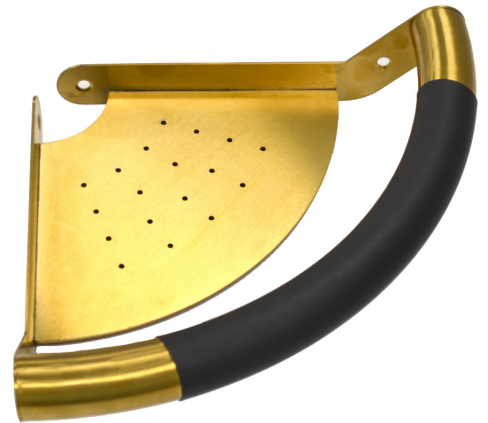

## LIQUID ACCENTS METAL CORNER SHELF

Single tier stainless steel shelf with grates modernizes any shower system.

- Made of sturdy, rust-resistant 304 stainless steel
- 12" across front, 9" on each leg
- Easy-to-Install with four stainless screws
- Available in Brushed Gold, Brushed Nickel, Chrome, Matte Black, Oil Rubbed Bronze



## SLOTTED CORNER “L” SHELF

This Contemporary storage option is another great storage option to finish your bathroom.

- Made of sturdy, rust-resistant metal
- Designed to fit any size wall
- Mounting stainless steel screws included
- Available in Brushed Gold, Brushed Nickel, Chrome, Matte Black, Oil Rubbed Bronze
- Dimensions: 8.75” x 2.75”



## RECTANGLE SLOTTED SHELF

Organize the bathroom area with this smart, space-saving shelving option.

- Made of sturdy, rust-resistant metal
- Designed to fit any size wall
- Mounting stainless steel screws included
- Available in Brushed Gold, Brushed Nickel, Chrome, Matte Black, Oil Rubbed Bronze
- Dimensions: 18” x 2.75” high (depth is 4.5”)





## 24" x 12" NICHE SHELF

A versatile storage solution with handy divider.

- Available in Signal Gray, Stainless Steel, Matte Black, and White
- Can be installed horizontally or vertically
- For use inside or outside the wet area
- Dimensions: 24" x 12"



## LIQUID ACCENTS SHOWER FOOT REST

Stainless steel shower foot rest is a safe option for your shower, while matching your fixtures.

- Made from sturdy, rust-resistant 304 Stainless Steel
- Four rubber, slip-resistant O-rings for better grip
- 13.25" long, 1" diameter
- Includes Mounting Hardware
- Available in Brushed Gold, Brushed Nickel, Chrome, Matte Black, Oil Rubbed Bronze



## CURVED SHOWER ROD

The curved shower rod is a beautiful bathroom storage option with a classic design, blending with any setting.

- Provides up to 7 inches of added interior space and 25% more elbow room than conventional rods
- 100% stainless steel construction (rod, flanges and covers)
- Secure mounting posts allow for multi-screw installation
- Unique flange pivots 180 degrees
- Complete mounting hardware included for drywall, wood and tile
- Brings curtain back at the corners preventing water from leaking out of the bath enclosure
- Dimensions:  
Fits 54", 60", 66" and 72" applications



## STRAIGHT SHOWER ROD

The straight shower rod provides a clean line and matches your other fixtures.

- 100% stainless steel construction (rod, flanges and covers)
- Secure mounting posts allow for multi-screw installation
- Complete mounting hardware included for drywall, wood and tile
- Available in Brushed Nickel, Chrome, Matte Black, Oil Rubbed Bronze\*, Polished Brass\* and White  
\*Only available for the 60" Rod
- Dimensions:  
Fits 60" and 72" applications





## MOEN COLLECTION

Complement the look of your new bath or shower with these beautiful fixtures from Moen.

- Available in Brushed Gold, Brushed Nickel, Polished Chrome, Matte Black and Oil Rubbed Bronze
- All brass construction
- Rust resistant fixtures

# MOEN®



\*This is a sampling. We also offer other Moen product lines.  
Contact your customer success representative for more information.

## DELTA COLLECTION

Add style and sophistication to your new bath or shower with these fixtures from Delta.

- Available in Polished Chrome, Brushed Nickel and Oil Rubbed Bronze

**Note:** Matte Black, Champagne Bronze and Brushed Gold are optional on some models



\*This is a sampling. We also offer other Moen product lines.  
Contact your customer success representative for more information.

# ***BATHTUB AND SHOWER SEATING***





## BATHTUB AND SHOWER SEATING



WALL MOUNTED BENCH SEAT  
W/SLATS

**SEACHROME 18"x16"**  
**1/2 FOLD DOWN**  
**SHOWER SEAT**  
**ORDER INFORMATION:**

SSB-180165-NW

White Naugahyde



WALL MOUNTED BENCH SEAT  
W/SLATS

**SEACHROME 18"x15"**  
**BENCH SEAT W/SLATS**  
**(WALL MOUNTED)**  
**ORDER INFORMATION:**

SSB2-180150-?

PW Phenolic White  
PT Teak



BENCH SEAT W/SWING  
DOWN LEG

**SEACHROME 24"x15"**  
**BENCH SEAT W/SWING**  
**DOWN LEG**  
**ORDER INFORMATION:**

SSB2-240150-?

PW Phenolic White  
TW Teak Wood  
WN White Naugahyde



BENCH SEAT W/SWING  
DOWN LEG

**SEACHROME 28"x15"**  
**BENCH SEAT W/SWING**  
**DOWN LEG**  
**ORDER INFORMATION:**

SSB2-280150-?

PW Phenolic White  
WN White Naugahyde



TEAK BENCH SEAT  
W/SWING LEGS

**SEACHROME 18"x15"**  
**TEAK BENCH SEAT**  
**W/SWING DOWN LEGS**  
**ORDER INFORMATION:**

SSB-180150-PT

Teak



TEAK FOLDING SEAT

**Liquid Accents Composite Seats**  
**(400# WEIGHT CAPACITY)**  
**ORDER INFORMATION:**

LA-CSEAT-????

See all color options on  
page 87



SILHOUETTE SLIMLINE WALL  
MOUNTED FOLDING  
SHOWER SEAT

**SILHOUETTE SLIMLINE**  
**WALL MOUNTED FOLDING**  
**SHOWER SEAT**  
**ORDER INFORMATION:**

SSB-185155-PBS  
SSB-185155-PWS

White  
Black



LIQUID ACCENTS TEAK  
FOLDING SEAT

**LIQUID ACCENTS SILHOUETTE**  
**CAMEO TEAK WOOD SEAT**  
**(400# WEIGHT CAPACITY)**  
**ORDER INFORMATION:**

LA-TSEAT-?

BN Brushed Nickel  
C Chrome  
MB Matte Black  
W White



L-SHAPE CUSHIONED  
SHOWER SEAT

**SEACHROME 28"x22.5"**  
**L-SHAPE CUSHIONED**  
**SHOWER SEAT (RIGHT HAND)**  
**ORDER INFORMATION:**

SSR-280225-?

NW White Naugahyde



L-SHAPE CUSHIONED  
SHOWER SEAT

**SEACHROME 28"x22.5"**  
**L-SHAPE CUSHIONED**  
**SHOWER SEAT (LEFT HAND)**  
**ORDER INFORMATION:**

SSL-280225-?

NW White Naugahyde



L-SHAPE SHOWER SEAT

**SEACHROME 32"x22.5"  
L-SHAPE SHOWER SEAT  
(LEFT HAND)  
ORDER INFORMATION:  
SSL-320225-?**

NW White Naugahyde  
PW Phenolic White



L-SHAPE SHOWER SEAT

**SEACHROME 32"x22.5"  
L-SHAPE SHOWER SEAT  
(RIGHT HAND)  
ORDER INFORMATION:  
SSR-320225-?**

NW White Naugahyde  
PW Phenolic White



L-SHAPE SHOWER SEAT

**22"x15"x19"H  
SHOWER SEAT  
(250# WEIGHT CAPACITY)  
ORDER INFORMATION:  
G-22 -?**

A Almond  
B Biscuit



TUB BENCH SEAT

**MOEN HOME CARE  
15"x28" TUB BENCH  
(250# WEIGHT CAPACITY)  
ORDER INFORMATION:  
BL-ST-28-W**

White



ADJUSTABLE TUB &  
SHOWER SEAT

**MOEN HOME CARE  
23.5"x14.2" ADJUSTABLE  
TUB AND SHOWER SEAT  
ORDER INFORMATION:  
MOE-DN7025**

White



TRANSFER BENCH

**MOEN HOME CARE  
22.2"x19.5"x8.8"  
TRANSFER BENCH  
ORDER INFORMATION:  
MOE-DN7065**

Glacier White



ADJUSTABLE TUB &  
SHOWER SEAT

**MOEN HOME CARE  
GLACIER SHOWER CHAIR  
(400# WEIGHT CAPACITY)  
ORDER INFORMATION:  
MOE-DN7100**

Glacier White



PREMIUM TRANSFER BENCH

**MOEN HOME CARE  
PREMIUM TRANSFER  
BENCH  
(400# WEIGHT CAPACITY)  
ORDER INFORMATION:  
MOE-DN7105**

Glacier White



ACRYLIC BENCH SEAT

**ACRYLIC BENCH SEAT  
(2000# WEIGHT CAPACITY)  
ORDER INFORMATION:  
LBS-(L/R)H-?**

Check color  
availability on page 57



HEXAGON CORNER SEAT

**Hexagon Corner Seat (900#  
weight capacity)  
Order information:  
LCNR-SS-?**

Check color  
availability on page 56

## LIQUID ACCENTS COMPOSITE SEAT

Beautiful and comfortable composite seat. Folds up to wall to save space when not in use.

- Constructed from grade A composite, powder-coated aluminum brackets and stainless steel hardware
- Impervious to water, salt water and rust
- Easy-to-clean, low-maintenance surface
- Splinter-free assurance
- No oiling required
- Mold and mildew resistant
- Removable back slats for easy cleaning
- Complies with ADA specifications (Holds up to 400 lbs)
- 5-year warranty
- Made in the U.S.A.
- **Dimensions:** 20"W x 17.125"D x 15.375"H



### SEAT HARDWARE FINISHES



MATTE BLACK (MB)

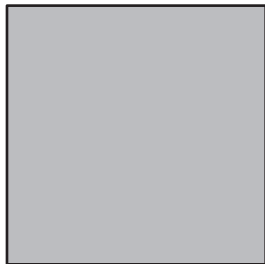

SILVER (SV)

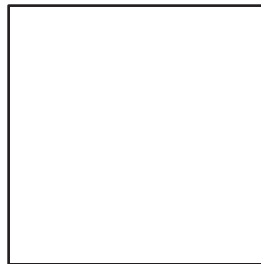

WHITE (W)

### COMPOSITE SLAT COLORS



BEIGE (BE)

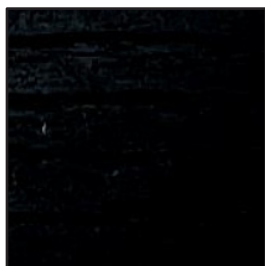

BLACK (BL)



GRAY (G)



HARBORWOOD (H)



WHITE (W)



# SAFETY SOFT

## SEATING & FLOORING

Get the ultimate safety and protection with Prime Bath's classic shower seat design.

- This material has been tested in the boating industry and by our Research & Development team, so you can rest assured that it will function beautifully in the bathroom.
- Permanent slip-resistant mat
- Peel & stick installation
- Beveled edge for drainage
- Lightweight polymer material
- Comes in White, Bright White & Gray
- Dimensions:
  - 33" x 13" for bathtubs
  - 24" x 12" bench seat
  - Corner Hexagonal Seat Mat
  - 6" x 6" seating and flooring sample
  - 39" x 20" large shower base, center drain
  - 20" x 20" large shower base, center drain
  - Alexis Walk-in Tub - Three-Piece set
  - 35" x 35" Neo Angle shower base
  - 38" x 38" Neo Angle shower base









# ***SHOWER AND BATHTUB DOORS***





## LIQUID ACCENTS ALPINE DOORS

Our new Alpine shower doors combine the stunning Rounded Euro Header Design with thick 5/16" glass panels

- 5/16" thick glass with Rounded Euro Header Design
- Comes in Single & Double Ladder Towel Bar variations
- 3" Bolt-thru Glass, Two-Wheeled, Hanging Brackets
- Easy-Glide Wheels
- Shower Dimensions:  
48" W x 70" H  
60" W x 70" H  
60" W x 76" H
- Tub Dimensions:  
60" W x 62" H
- Available in Brushed Nickel, Chrome, Matte Black and Oil Rubbed Bronze
- Towel bar sizes:  
18" (48" doors)  
24" (60" doors)



### STANDARD HANDLE

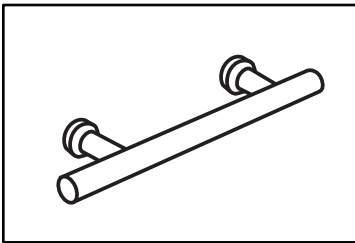

One or Two Ladder Towel Bars

### OPTIONAL HANDLE

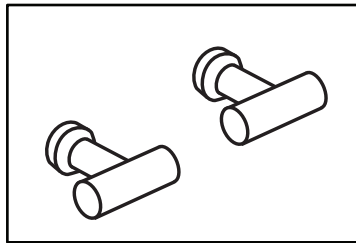

Two Replacement Knobs

### GLASS FINISHES



Clear

### FRAME FINISHES



Brushed  
Nickel



Chrome

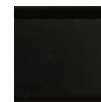

Matte  
Black

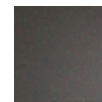

Oil Rubbed  
Bronze

# LIQUID ACCENTS ARIES DOORS

Our Aries shower door is ideal for narrow enclosures. Easy to install and design allows for adjustable widths.

- Pivot outswing door
- 1/4" clear glass only
- 22"-24" door opening
- Double sided 8" C-Pull Handles
- Polycarbonate sweep
- Reversible
- Fits multiple pan sizes
- Available in Brushed Nickel, Chrome and Matte Black
- Dimensions:
  - 29" – 31" W x 72" H
  - 31" – 33" W x 72" H
  - 33" – 35" W x 72" H
  - 38 1/2" – 41 1/2" W x 72" H
  - 44 1/2" – 47 1/2" W x 72" H



## STANDARD HANDLE

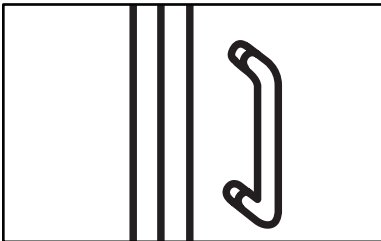

Single sided 8" C-Pulls  
w/ Finger Pulls

## OPTIONAL HANDLE

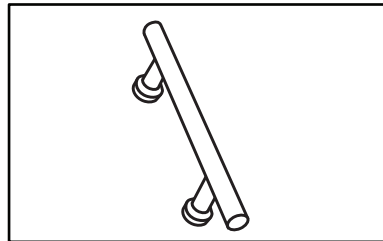

Single sided Ladder Pulls  
w/ Finger Pulls

## GLASS FINISHES



Clear

## FRAME FINISHES



Brushed  
Nickel



Chrome

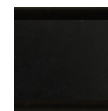

Matte  
Black

## LIQUID ACCENTS DENALI DOORS

Elegant and modern “barn door” style look with rectangular glide bar. Specially designed roller bearings and padded stoppers allow for quiet, easy movement of the door.

- 5/16” (or .3125”) thick glass
- Two, sliding glass doors
- Two Ladder Pulls and Two Knobs included
- Dimensions:  
48” W x 74” H  
60” W x 74” H
- Available in Brushed Nickel, Chrome, Matte Black and Oil Rubbed Bronze\*
- Universal design works with right or left plumbing



### GLASS FINISHES



Clear

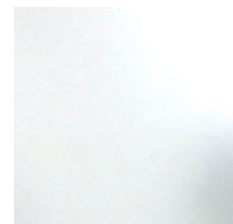

Frost\*

### FRAME FINISHES

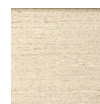

Brushed  
Nickel



Chrome

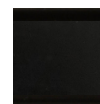

Matte  
Black

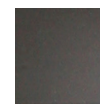

Oil Rubbed  
Bronze\*

\*Frost glass is only available for the 60” W models

\*Oil Rubbed Bronze finish is only available for the 48” W model



# LIQUID ACCENTS DENALI DOORS - VERTICAL HANDLES

Our Top Selling Denali door now comes in a vertical handle model. Now homeowners have even more choices when it comes to beautiful “barn doors”.

- 5/16” (or .3125”) thick glass
- Two, sliding clear glass doors
- One Ladder Pull and Two Knobs
- Dimensions:  
48” W x 74” H  
60” W x 74” H
- Available in Brushed Nickel, Chrome, Matte Black and Oil Rubbed Bronze\*
- Universal design works with right or left plumbing



## STANDARD HANDLE

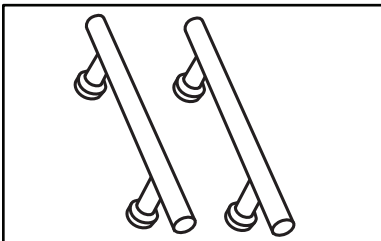

Two single sided Ladder Pulls  
w/ Finger Pulls

## GLASS FINISHES



Clear

## FRAME FINISHES



Brushed  
Nickel



Chrome

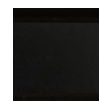

Matte  
Black

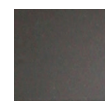

Oil Rubbed  
Bronze\*

**\*Oil Rubbed Bronze finish is only available for the 48”  
W model**

## LIQUID ACCENTS DENALI DOORS - TUB HEIGHT

Our Top Selling Denali door now comes in a Tub Height to complete the perfect bath and shower combination.

- 5/16" (or .3125") thick glass
- Two, sliding clear glass doors
- Two Ladder Pulls and Two Knobs included
- Dimensions: 60" W x 62" H
- Available in Brushed Nickel, Chrome, Matte Black, and Oil Rubbed Bronze
- Universal design works with right or left plumbing



### GLASS FINISHES



Clear

### FRAME FINISHES



Brushed  
Nickel



Chrome



Matte  
Black

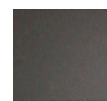

Oil Rubbed  
Bronze

# LIQUID ACCENTS EVEREST DOORS

Our Everest series door is designed to fit into any bathroom. The square header combined with the two square 8" pull handles completes this modern style.

- 22-24" door opening
- Includes two rounded 8" C-Pull Handles with Finger Pulls
- Available in Chrome, Brushed Nickel, Matte Black, and Oil Rubbed Bronze
- Clear and rain glass
- Shower Dimensions:  
48" W x 70" H  
60" W x 70" H  
60" W x 76" H
- Tub Dimensions:  
60" W x 57" H  
60" W x 62" H



## STANDARD HANDLE

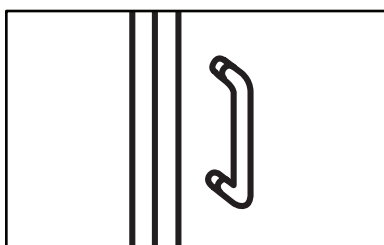

Two single sided 8" C-Pulls  
w/ Finger Pulls

## OPTIONAL HANDLE

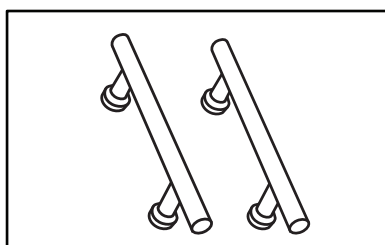

Two single sided Ladder Pulls  
w/ Finger Pulls

## GLASS FINISHES

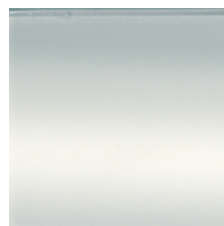

Clear

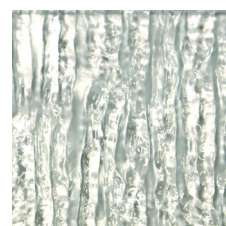

Rain\*

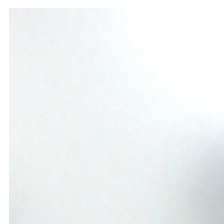

Frost\*

## FRAME FINISHES



Brushed  
Nickel



Chrome

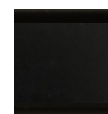

Matte  
Black

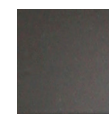

Oil Rubbed  
Bronze

\*Frost glass & Rain glass are not available in all sizes



## LIQUID ACCENTS GLACIER DOORS

Our shower doors will make your bathroom appear more spacious, reflecting light and enhancing your space.

- 1/4" thick glass with Rounded Header
- Towel bar handle and 2 Finger Pulls drilled through glass
- Shower Dimensions:
  - 48" W x 70" H
  - 60" W x 70" H
  - 66" W x 70" H (Clear Glass Only)
  - 72" W x 70" H (Clear Glass Only)
- Tub Dimensions:
  - 60" W x 57" H
  - 60" W x 62" H
- Available in Brushed Nickel, Chrome, Matte Black, and Oil Rubbed Bronze
- Extra towel bar options:
  - 18" (48" doors)
  - 24" (60" doors)



### STANDARD HANDLE

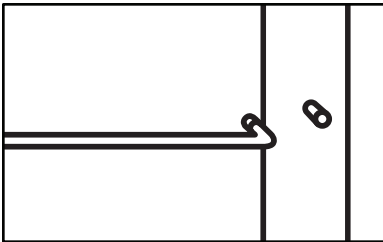

Single Towel Bar w/ Finger Pulls

### OPTIONAL HANDLE

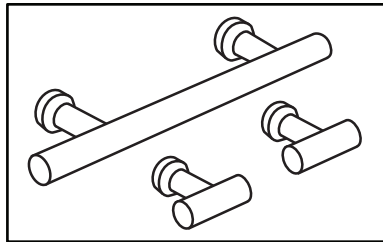

Additional Ladder Bar

### GLASS FINISHES

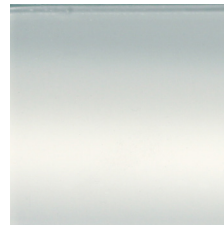

Clear

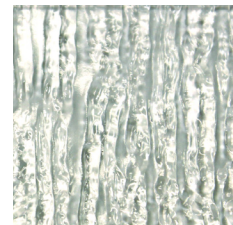

Rain\*

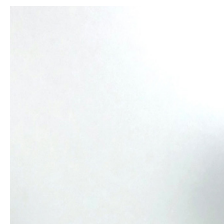

Frost\*

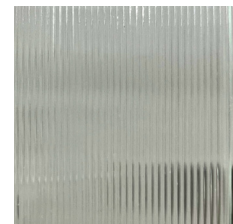

Corrugated\*

### FRAME FINISHES



Brushed Nickel



Chrome

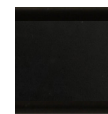

Matte Black

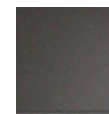

Oil Rubbed Bronze

\*Frost glass & Rain glass are not available in all sizes

\*Corrugated only available for 60" W x 70" H models

## K2 DOUBLE THRESHOLD ENCLOSURE

Our K2 Double Threshold shower door is ideal for BCI shower bases fitted against only 2 room walls.

- Outswing Hinge Door
- Includes One Double-Sided Vertical Ladder Pull
- Available in Chrome, Brushed Nickel, & Matte Black
- 1/4" Clear Glass Only
- Includes Polycarbonate Sweep
- Glass Protection Included
- Only designed to fit BCI manufactured Double Threshold Shower Pans
- Dimensions:  
32" – 32" W x 72" H  
36" – 36" W x 72" H



### GLASS FINISHES

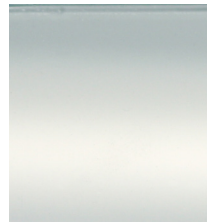

Clear

### FRAME FINISHES



Brushed  
Nickel



Chrome



Matte  
Black

## K2 NEO-ANGLE ENCLOSURE

Our K2 Neo-Angle Enclosure is designed to fit the BCI Neo-Angle Shower Pans. Fit your dream shower into any corner with assurance of a premium glass enclosure.

- 1/4" thick Clear glass
- Outswing Hinge Door
- Includes One Double-Sided Vertical Ladder Pull
- Available in Chrome, Brushed Nickel, & Matte Black
- Glass Protection Included
- Dimensions:  
35" – 35" W x 72" H  
38" – 38" W x 72" H



### GLASS FINISHES



Clear

### FRAME FINISHES



Brushed  
Nickel



Chrome



Matte  
Black



# LIQUID ACCENTS GLACIER TALL DOORS

Our shower doors will make your bathroom appear more spacious, reflecting light and enhancing your space.

- 1/4" thick glass
- One towel bar and two knobs included
- Easy glide wheels, roller brackets
- Euro style header
- Dimensions:  
48" W x 76" H  
60" W x 76" H
- Available in Brushed Nickel, Chrome, Matte Black and Oil Rubbed Bronze
- Extra towel bar options:  
18" (48" doors)  
24" (60" doors)



## STANDARD HANDLE

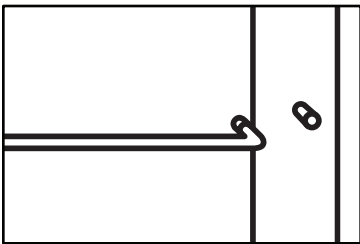

Single Towel Bar w/ Finger Pulls

## OPTIONAL HANDLE

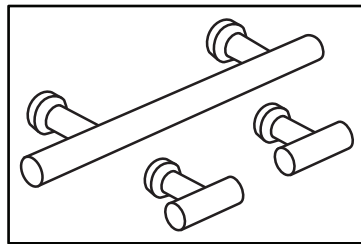

Additional Ladder Bar

## GLASS FINISHES

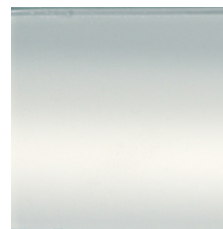

Clear

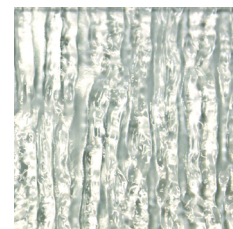

Rain\*

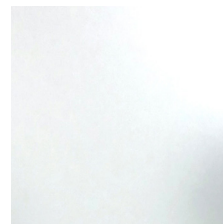

Frost\*

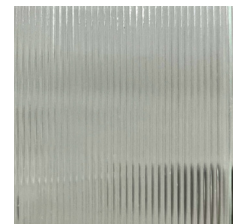

Corrugated\*

## FRAME FINISHES

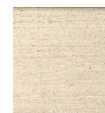

Brushed Nickel



Chrome

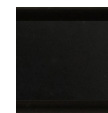

Matte Black

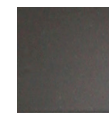

Oil Rubbed Bronze

\*Frost glass & Rain glass are not available in all sizes

\*Corrugated only available for 60" W x 76" H models

## LIQUID ACCENTS GLACIER S-CURVE DOORS

Elevate the appearance of your bathroom design with the new Glacier in S-Curve glass. The same beautiful Glacier doors with new lines for a unique appearance.

- 1/4" thick glass
- Rounded header
- Towel bar handle and 2 Finger Pulls drilled through glass
- Shower Dimensions:  
60" W x 70" H  
60" W x 76" H
- Tub Dimensions:  
60" W x 62" H
- Available in Brushed Nickel, Chrome, Matte Black and Oil Rubbed Bronze
- Optional 24" towel bar available



### STANDARD HANDLE

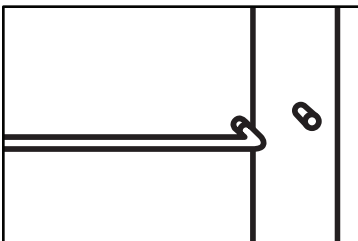

Single Towel Bar w/ Finger Pulls

### OPTIONAL HANDLE

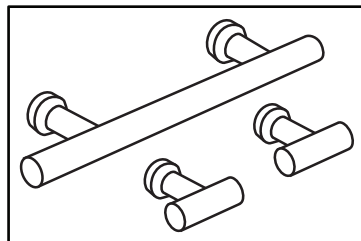

Ladder Towel Bar w/ Finger Pulls

### GLASS FINISHES



Clear

### FRAME FINISHES



Brushed Nickel



Chrome

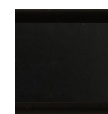

Matte Black

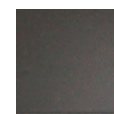

Oil Rubbed Bronze

# LIQUID ACCENTS GLASS PARTITION

Our Glass Partition is a perfect fit for a modern finish with a static panel of glass.

- Heavy 3/8" thick glass
- Available in Four Finishes
- Glass Protection Included
- Dimensions:  
32" W x 74" H  
36" W x 74" H



## GLASS FINISHES



Clear

## FRAME FINISHES



Brushed  
Nickel



Chrome

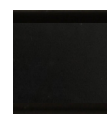

Matte  
Black

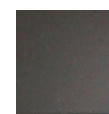

Oil Rubbed  
Bronze



## INVISIBLE SHIELD

Protect your new shower door with Invisible Shield Pro 15 Coating Wipes.

- Easy application with instructions included
- Repels water, soil, rust & minerals
- Prevents excess soiling, staining & corrosion
- Makes cleaning easier & improves appearance



# ***INSTALLATION PRODUCTS***





## LUX-BOND ADHESIVE KIT

A proper tub installation starts with Lux-Bond Adhesive.

- Kit includes:
  - (4) Containers / 2-Part Catalyst and Resin
  - (1) Tube of Super Tach
  - (1) Roll Foam Tape
  - (1) Overflow Gasket





# SINGLE WALL ADHESIVE KIT BUTYL ROUND TAPE

Get the perfect amount for a single wall and adhesive installation.

- Kit includes:
  - (1) Sheet of foam tape
  - (2) Tubes of Super Tach
  - (1) Tube of finish sealant (color)



1/4" Thick Round Butyl Tape for mounting accessories.

- Exceptional tack and adhesion
- 20' Rolls
- Fully tested & proven in the field



## AVAILABLE IN:

White  
Almond  
Biscuit  
Gray  
Sandbar

Arctic Ice  
Canyon Rock  
Sandalwood  
Santa Cruz Granite  
Sierra Sand

White Travertine

## FINISH SEALANT KIT

Get that perfect finished with Prime Baths's sealant.

- Improved flow rate
- Born on date (Date manufactured for tracking)
- Color identification on tube
- 12-18 Month shelf-life



# FULL WALL INSTALLATION KIT

For a FULL wall treatment and all your adhesive needs.

- Full wall installation system contains:
  - (2) Tubes of finish sealant (colored)
  - (11) SuperTach® Wall Adhesive
  - (5) Acrylic foam tape sheets
  - (1) Roll round tape



## AVAILABLE IN:

White	Arctic Ice	White Travertine
Almond	Canyon Rock	
Biscuit	Sandalwood	
Gray	Santa Cruz Granite	
Sandbar	Sierra Sand	



## CAULK PRIMER

Caulk Primer primes the acrylic for improved adhesion with silicone sealants.

- Lot and expiration dates printed on label

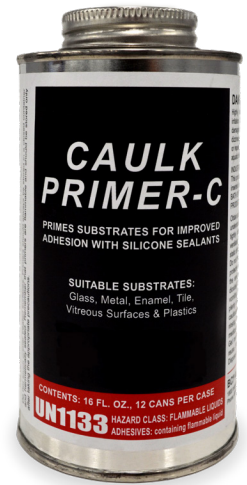

## SAUSAGE PACK

- No waste using sausage packs
- Sausage caulk guns distribute adhesive quickly and more efficiently than cartridges
- Each sausage pack contains 20 oz.



SL-1-DFWA (SINGLE)  
SL-16-DFWA (CASE)

# INSTALLATION TOOLS

Use these specially designed tools to accurately transfer wall and tub measurements, simplify installation, bend and repair acrylic surfaces.



WALL TEMPLATE



TUB INSTALLATION TEMPLATE



MEASURING TOOL SET

## WALL TEMPLATE ORDER INFORMATION:

WT-L Large

WT-S Small

## TUB INSTALLATION TEMPLATE ORDER INFORMATION:

TT

## MEASURING TOOL SET ORDER INFORMATION:

3-PC

## PORTABLE BENDING TOOL ORDER INFORMATION:

1729900-180

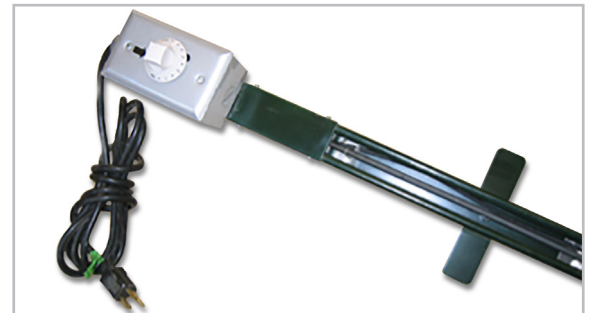

PORTABLE BENDING UNIT



**DRAIN CENTERING TOOL**



**DRAIN FORMING TOOL**



**REPAIR KIT**

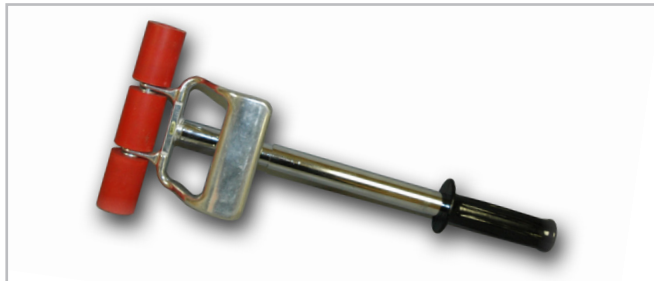

**INDUSTRIAL ROLLER**



**COLOR-MATCHED REPAIR KIT**



**SCRATCH REMOVER KIT**



**FUGENBOY CAULK FINISHING TOOL KIT**

**DRAIN CENTERING TOOL  
ORDER INFORMATION:**  
DR-CENTERPUNCH

**DRAIN FORMING TOOL  
ORDER INFORMATION:**  
DR-FORMINGTOOL

**INDUSTRIAL ROLLER  
ORDER INFORMATION:**  
L-WALLROLLER

**SCRATCH REMOVER KIT  
ORDER INFORMATION:**  
SREM-KIT

**SCRATCH REPAIR KIT  
ORDER INFORMATION:**  
SREP-KIT

**COLOR-MATCHED REPAIR KIT  
ORDER INFORMATION:**  
17298-?-350

04 White  
01 Almond  
02 Biscuit

**FUGENBOY CAULK  
FINISHING TOOL KIT  
ORDER INFORMATION:**  
CFT-KIT



# INSTALLATION TOOLS

A Complete kit for Installation of bathtubs, shower bases and walls.

Contains the following items:

- 12" Hacksaw
- 48" Level
- 24" Level
- 72" Straight Edge
- Bosch T101BF 5 pc. 4" 10 TPI Variable Pitch Clean for Hardwood T-Shank Jig Saw Blades
- Channel Lock
- 6-in-1 Screwdriver
- 6" Adjustable Wrench
- 10" Pipe Wrench
- Basin Wrench
- Slip Nut Wrench
- 10 Piece Metric Hex Key
- 10 Piece Safe Hex Key
- East Wing 16oz Hammer
- Wiss Straight Cut Snips
- (3) 4'x15' Canvas Drop Cloth
- Inside PVC Pipe Cutter
- Deburring Tool
- Shoe Covers - 3 Pack
- Dust Masks - 5 Pack
- Speed Square 7"
- Firm Grip Gloves - 3 Pack
- 6-in-1 Painters Tool
- 12" Wonder Bar
- Locking Pliers - 2 Pack
- Fixed Jab Saw
- 16' Tape Measure
- Drill Bits - 7 Pack
- Tile Bits - 3 Pack
- Rigid Pipe Cutter
- Teflon Tape
- Broom and Dustpan
- 1-1/4" Whole Saw
- 5 Gallon Bucket
- (2) Rolling Bin
- Terry Cloth Rags - 20 Pack
- Denatured Alcohol
- Precision Screw Driver
- Cordless Power Tools
- Pen Light
- Flat Razor Blades - 10 Pack
- Cordless Caulking Gun
- Parts Container Tough Case
- Bucket Boss
- Sharpies - 2 Pack
- Toilet Armor









# ***SALES TOOLS***





## BATHROBE

The perfect housewarming gift/signing bonus for your newly signed customer! Unisex bathrobe delivers all the work-from-home comfort one needs, morning or night. Made with 100% cotton, this ever-cozy and versatile robe features a relaxed fit with a shawl collar, long sleeves, self-tying waist sash, and three convenient pockets.

- 100% thick cotton
- 3 Pockets
- Machine washable
- Available in white



## MATERIAL SAMPLE BOOK

Wall color samples for entire product line.

- Samples are three-hole drilled for easy removal
- Divider pages feature new photography
- New colors included
- Dimensions: 11.5" x 11.5" x 3.5" Binder



## ***MICRO TUB PROMO***

The mini tub promo sample is perfect for showing in the home.

- Constructed from DR-ABS acrylic
- Spray foam backed
- Available in White
- .25" Thick
- Dimensions: 10.5"L x 5.5"D x 2.75"



## ***MICRO SHOWER PROMO***

The mini shower promo sample is perfect for showing in the home.

- Constructed from DR-ABS acrylic
- Spray foam backed
- Available in White
- Over .125" Thick
- Dimensions: 8.5"L x 7.25"D x 1.25"H



## MINI SHOWER DOOR SAMPLE

The Mini Shower Door sample is perfect for showing to homeowners.

- Sample of Liquid Accents shower door
- Comes with a durable carrying bag
- Available in Brushed Nickel, Chrome, Matte Black, Oil Rubbed Bronze, and Signal Gray



## MINI COMPOSITE SEAT SAMPLE

The perfect all-in-one tool for the new Liquid Accents Composite Seat. All color options can be visualized in one portable display.

- Scale model of the Composite Seat
- All hardware and slat color options are represented
- slat color names are etched into the material
- Dimensions: 8.5"W x 7.25"H x 6.5"D





# CARE AND WARRANTY





# BATH CARE AND MAINTENANCE INSTRUCTIONS

## How to care for your beautiful, new acrylic bath or shower & wall system

### GENERAL CLEANING INSTRUCTIONS:

For normal everyday cleaning, BCI suggests using our very own Eliminate. It is factory-approved distinctly for all of our acrylic products. It is available for sale from your local dealer. You may also use Formula 409 or Microban 24 Hour. The use of scouring pads or abrasive cleansers will dull the surface. Should you wish to use a product not listed below, test on a small area in the corner of the skirt before applying to the entire bathtub liner. Always review individual cleansers' instructions. Rinse thoroughly after cleaning.

### RECOMMENDED CLEANERS:

BCI Eliminate, Microban 24, Formula 409, White vinegar and water may also be used to soften mineral deposits. Use 1/2 cup Clorox Bleach per gallon of water as a disinfectant.



### DO NOT USE\*:

- Original Clean Shower
- Clean Shower for Plastic Showers & Glass
- Ammonia
- Aerosols
- Acetone
- Soft Scrub
- Dawn dish soap
- Dow disinfectant cleaner
- Scrub Free
- Fingernail polish remover
- Scouring pads
- Lestoil
- Lysol disinfectant cleaner

*Use of these chemicals could cause a dull surface and chemical cracks. This will void your product warranty.*

There is no need to use abrasive cleaners. Abrasive cleaners dull the gloss over a period of years. In extreme cases where the recommended cleaners do not work, use a Chore Boy or 3M Sponge pad. Make sure you use only the ones recommended for Teflon or non-stick surfaces.

### DRAIN CLEANER:

CAUTION: Liquid drain cleaners are recommended over powders and/or crystal; however, when using liquid drain cleaning agents, bail the standing water out of the bathtub and remove the drain plug. Use a funnel to prevent spills and apply the chemicals directly down the drain. Always make certain that chemicals do not come in contact with the acrylic surface.

*Use drain cleaners sparingly, so that they do not boil out and attack the acrylic surface.*

**NOTE:** Silicone is resistant to paint.

# LIFETIME LIMITED WARRANTY



## BCI ACRYLIC, INC. WARRANTY

### LIMITED LIFETIME MANUFACTURER'S PRODUCT AND WORKMANSHIP WARRANTY

**BCI ACRYLIC, INC. an Illinois corporation** d/b/a Bath Planet d/b/a Luxury Bath d/b/a Bath Makeover d/b/a Prime Baths ("BCI") manufacturer of the acrylic wall surrounds, shower floors/bases, replacement bathtubs, bath liners, shower liners and acrylic accessories (collectively referred to as "Product") warrants to any residential purchaser of the BCI Product ("Customer") that its Product will be free of material defects for as long as the residential Customer owns the real property ("Property") where the BCI Product was installed. Customer may transfer this Warranty to a subsequent buyer of Customer's residence. ("Warranty Transfer") A Warranty Transfer will only be effective if made within 2 years of the Product Installation and/or the Customer has not engaged in conduct that would void the Warranty. **THIS WARRANTY EXCLUDES ANY WARRANTY FOR CLAIMS RELATING TO INSTALLATION/LABOR OF BCI PRODUCTS. THIS WARRANTY IS FOR PRODUCT DEFECTS ONLY. BCI DOES NOT WARRANT ANY NON-BCI MANUFACTURED PRODUCTS SUCH AS FAUCETS, SHOWER HEADS, DOORS, GRAB RAILS, AND/OR STOPPERS.**

BCI warrants that the surface of the Product will not materially fade, yellow, crack, bubble, or peel under normal use and when cared for under the guidelines set forth by BCI. This warranty expressly prohibits the use of unapproved cleaners, and expressly excludes damage resulting from the use of same. In addition, this warranty is void if damage is caused by contact with any of the following: dyes, paints, inks, certain cosmetics, or cleaning agents, abrasive pads, pigments, certain foods, paint remover, fingernail polish remover, solvents or other chemicals, cigarettes or other sources of extreme heat, or abuse of any kind whether intentional or unintentional. Additional exclusions include escutcheon plates, valve handles, hand-held shower head hoses and other materials not manufactured by BCI (in which case the normal manufacturer's warranty of each product applies).

In the event of a failure of the Product, as a result of a material effect to the Product that is not caused by the Customer, BCI reserves the right to partially repair, completely replace, or provide a full or partial refund, whichever BCI deems appropriate in its sole discretion.

Customers may make a warranty claim in writing with the BCI Dealer with which Customer originally contracted with. Upon notice to BCI of any warranty claim, BCI will take steps to assess the claim, determine a course of action and effectuate repair or other remedy under the terms of this warranty for covered Products. Any warranty work is subject to then current lead times and then current product availability. Should the BCI Dealer from which the Customer originally contracted for service is no longer in business, or should the Customer not be able to satisfactorily resolve a warranty issue with the BCI Dealer, the Customer should make a warranty claim in writing with BCI at:

**BCI ACRYLIC, INC.**  
**C/O CUSTOMER SUCCESS DEPARTMENT**  
**1800 INDUSTRIAL DRIVE, LIBERTYVILLE, ILLINOIS 60048**  
**800.963.8827**

The invalidity of any provision of this warranty shall not invalidate the remaining provisions of this warranty.

**ANY CLAIM FILED BY THE CUSTOMER TO ENFORCE THE TERMS AND CONDITIONS OF THIS WARRANTY SHALL BE FILED IN THE STATE OR FEDERAL COURTS LOCATED IN COOK COUNTY, ILLINOIS TO THE EXCLUSION OF ALL OTHER JURISDICTIONS. THIS WARRANTY IS IN LIEU OF ALL WARRANTIES, EXPRESSED OR IMPLIED, AND IS IN FACT THE ONLY WARRANTY OFFERED BY BCI. UNDER NO CIRCUMSTANCES WILL BCI BE LIABLE FOR INCIDENTAL, INDIRECT, SPECIAL, PUNITIVE, EXEMPLARY OR CONSEQUENTIAL DAMAGES, DAMAGE TO PERSONAL PROPERTY, LOST PROFITS, LEGAL SERVICES AND LEGAL FEES, AND/OR LOSS OF TIME OR TRAVEL UNDER THIS WARRANTY. THIS WARRANTY EXPRESSLY EXCLUDES LOSS OF VALUE, LOSS OF USE, STIGMA AND DIMINUTION IN VALUE RELATED TO ANY COVERED FAILURE CLAIMED UNDER THIS WARRANTY. IN NO WAY SHALL THE TOTAL LIABILITY OF BCI EXCEED THE TOTAL AMOUNT PAID BY THE CUSTOMER FOR SERVICES PROVIDED AND/OR THE GOODS PURCHASED. THE CUSTOMER SPECIFICALLY WAIVES ALL IMPLIED WARRANTIES AND THE WARRANTY FOR FITNESS FOR A PARTICULAR PURPOSE AND/OR THE IMPLIED WARRANTY OF HABITABILITY. THIS WARRANTY GIVES THE CUSTOMER CERTAIN LEGAL RIGHTS. SOME STATES DO NOT ALLOW LIMITATIONS OF THE IMPLIED WARRANTIES OR CONSEQUENTIAL DAMAGES, SO THESE LIMITATIONS MAY NOT APPLY TO YOU. SUBJECT TO APPLICABLE LAWS THIS WARRANTY APPLIES TO ALL SUCH LIMITATIONS TO THE FULLEST EXTENT ALLOWED BY LAW. THE WARRANTY OBLIGATIONS OF BCI ARE VOID AND OF NO EFFECT IF THE CUSTOMER HAS FAILED TO PAY FOR ANY GOODS OR SERVICES. THIS WARRANTY ONLY EXTENDS TO THE PRODUCTS AS DEFINED HEREIN AND EXCLUDES ALL OTHER PRODUCTS, SERVICES OR LABOR THAT MAY HAVE BEEN PROVIDED TO YOU.**

06\_22



## FRACTION TO DECIMAL CONVERSION CHART



1/16	0.0625
1/8	0.125
3/16	0.1875
1/4	0.25
5/16	0.3125
3/8	0.375
7/16	0.4375
1/2	0.5
9/16	0.5625
5/8	0.625
11/16	0.6875
3/4	0.75
13/16	0.8125
7/8	0.875
15/16	0.9375

**PRIME**

**TIME**